

Overhead view

CRIB® TPRS CARRIER LITERATURE CANISTER INSTALLATION GUIDE

BASE PIECES

1. CRIB TPRS Carrier (1 piece)
2. Literature Canister Lid (1 piece)
3. Literature Canister (1 piece)
4. Tube Mounting Hole (2 Locations)

BASE HARDWARE

5. 1/4-20 x 5/8" Screw (2 piece)
6. 5/8" Washer (2 pieces)
7. 1/4-20 Locknut (2 pieces)

TOOLS REQUIRED:

1. 7/16" Wrench
2. 5/32" Allen Wrench (Hex Key)

INTRODUCTION

Introducing another product improvement by PSS to CRIB TPRS Carrier--an easy-open document and hardware canister. This canister allows for quick access to relevant RoadQuake® literature and RoadQuake Breakaway Link Repair hardware. The supplied canister will include the CRIB Canister Installation Guide, a "rollable" version of the RoadQuake Best Practices, and one RoadQuake Breakaway Link Repair Kit. Instructions for installing your canister are printed on the reverse side of this document.

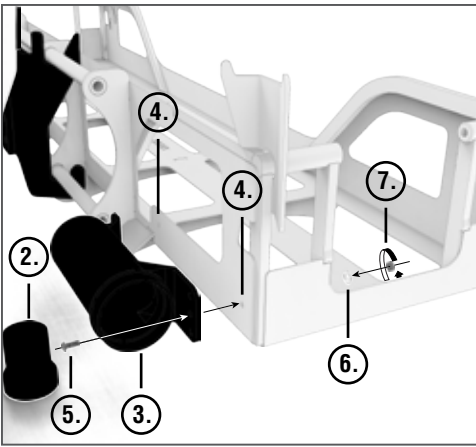

STEP 1

Locate the **Tube Mounting Holes** (#4) on the driver side of a rear mounted CRIB. Remove the **Literature Canister Lid** (#2). Insert the **1/4-20 x 5/8" Screw** (#5) with the **5/8" Washer** (#6) through the center hole on front mounting flange of the **Literature Canister** (#3) and through the right **Tube Mounting Hole** (#4). Finger tighten the **1/4"-20 Locknut** (#7). Be sure to have the open side of Literature Canister facing outward.

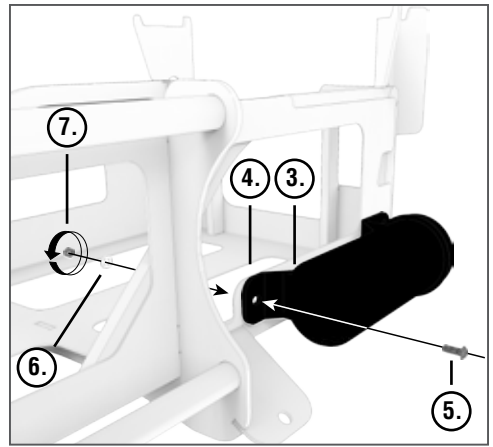

STEP 2

While holding the **Literature Canister** (#3) in place, insert the **1/4-20 x 5/8" Screw** (#5) with the **5/8" Washer** (#6) through the hole on back mounting flange of the **Literature Canister** (#3) and through the left **Tube Mounting Hole** (#4). Finger tighten the **1/4"-20 Locknut** (#7).

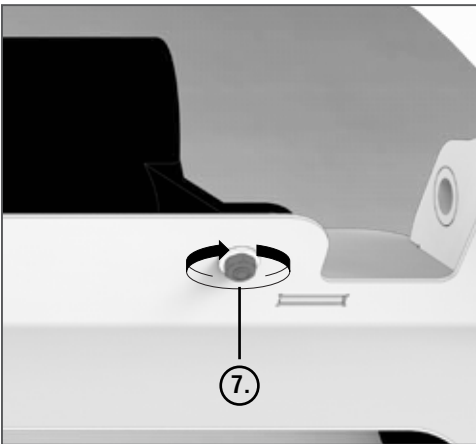

STEP 3

Tighten both **1/4"-20 Locknuts** (#7) on the inside of CRIB using the Allen Wrench to secure the head of the bolt. Be sure to not to scratch the paint.

Follow us on:

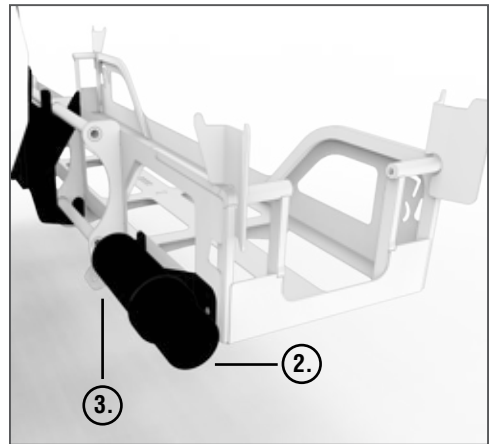

STEP 4

Place all desired items inside the **Literature Canister** (#3) and screw the **Literature Canister Lid** (#2) back on.