

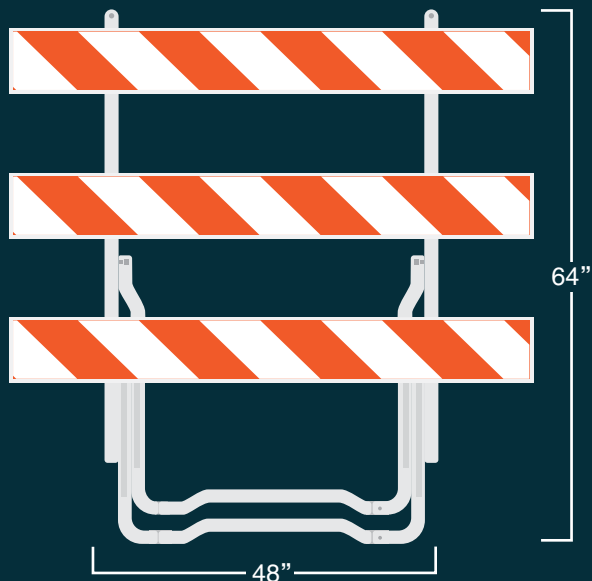

## LANEGARD3®

FOLDING TYPE III BARRICADE



*LaneGard 3 folded is shown above*

### DEPLOY, FOLD, AND STORE

LaneGard 3® folds for transport and storage, with PSS Wave Centerboards attached. Unfolds for deployment.

When deployed LaneGard 3 uprights has a footprint of 46"x48" and is 64" tall. The true width of LaneGard 3 will depend on how long of Wave Centerboards are mounted on it. Wave Centerboards are available in 4', 6', and 8' lengths. When folded, LaneGard is 48"x73.75"x2.562".



### LANEGARD FEATURES

- » Made from engineered plastic with UV inhibitors.
- » Weighs 17 lbs. assembled, without centerboards.
- » Molded-in Warning Light Mount accepts LED Warning Lights.
- » Molded through-holes recessed for flushmounted hardware.
- » Designed for use with PSS Wave Centerboards. PSS Wave Centerboard available in 4', 6', 8' lengths.
- » Retroreflective sheeting meets all state and federal specifications. Available in Engineer, Hi-Intensity and Diamond grades.
- » Anti-Skid Feet, two per cross-bar.



# LANEGARD3<sup>®</sup>

FOLDING TYPE III BARRICADE



We use 3M  
Reflective  
Sheeting.

## LANEGARD<sup>®</sup> 3 UPRIGHT FEATURES:

LaneGard 3 folds for transport and storage and unfolds for use with PSS Wave Centerboards attached. Measures less than 3" thick when folded. Once assembled, always assembled.

1. Molded-in Warning Light Mount accepts LED warning lights.
2. Molded through-holes recessed for flush-mounted hardware.
3. Use sandbags or PSS tire collars for additional ballast.
4. Anti-Skid Feet can provide additional stability. Two per crossbar.



## FHWA LETTER:

Letter: WZ-336  
Tested to Manual for Assessing Safety Hardware  
(MASH) Test Level: 3

## LANEGARD<sup>®</sup> 3 FEATURES:

One-piece design folds for storage and transport and unfolds for use. Sets up and tears down in seconds. One person can easily fold and unfold LaneGard 3 for transport and deployment. Weighs 17 lbs without centerboards.

LaneGard 3 is designed for use with PSS Wave<sup>®</sup> Centerboards. Available in 4', 6', and 8' lengths. Retroreflective sheeting is available in Engineer, Hi-Intensity, and Diamond Grades. Retroreflective sheeting meets all state and federal specifications. Wave accepts sheeting on one or both sides.



We are a proud member of: