



AUDIBLE INFORMATION DEVICE
— FIELD GUIDE —

[CLICK HERE FOR
THE PARAKEET
STARTER KIT](#)



Part of the RightPath™ brand product line.

Version 0.17 10-3-24

CONTACT:

Call 800-662-6338 to talk to a Customer Service Representative.

HOURS:

8 AM to 5 PM (V.)
Monday through Friday



PARAKEET INDICATOR LIGHT INDEX

LEDs ACTIVE STATUS	DESCRIPTION	VISUAL INDICATION
All LEDs Solid Amber	Parakeet is booting up	
All LEDs Flashing Green	Parakeet has booted up and is ready for calibration	
All LEDs Solid Red	Parakeet is recording mic audio	
LED F1 Flashing Amber	Parakeet is calibrating	
LED F1 Flashing Green	Parakeet is active and sensing	
LED F2 Flashing Red	Movement detection deactivated	
LED F3 Flashing Amber	Volume up button pressed when volume adjust button not activated	
LED F4 Blinks Once Amber	Volume down button pressed when volume adjust button not activated	
LED F2 Flashing Amber	Parakeet is playing audio for volume adjustment	
LED F3 Flashing Green	Volume up button (F3) pressed and volume increased	
LED F4 Flashing Green	Volume down button (F4) pressed and volume decreased	
LED F4 Flashing Amber	Batteries are low, replace soon	
LED F4 Flashing Red	Batteries are critically low, replace immediately	
After Pressing And Holding The F2 Button For Four Seconds, LED F4 Flashes Red One To Five Times or Green six to Ten Times	To check Parakeet battery charge, press and hold the F2 button for four seconds. The F4 LED will flash either red or green in increments of 10% according to charge level. When the battery life is at 60% or higher, the F4 LED will flash green a corresponding amount of times, when it is below 60% it will flash red. Example: After holding the F2 button for four seconds, if the Parakeet has a 30% charge, the F4 light will flash red three times.	<p>10% - 50%</p> 1-5x <p>60% - 100%</p> 6-10x

PARAKEET INDICATOR LIGHT ERROR INDEX

LEDs ACTIVE STATUS	DESCRIPTION	POTENTIAL FIX	VISUAL INDICATION
Upon Booting Parakeet, LED F2 Flashing Red	No SD Card Detected	Check to see if the SD card is inserted and mounted fully	
Upon Booting Parakeet, LED F3 Flashing Red	Ambient Microphone Not Detected	Reboot the Parakeet. If the error persists, there is a hardware issue. Contact PSS.	
Upon Booting Parakeet, LED F4 Flashing Red	Ultrasonic Sensor Not Detected	Reboot the Parakeet. If the error persists, there is a hardware issue. Contact PSS.	

STEP 1

Place the **Parakeet (J)** on the flush side of the **traffic safety device (K)**. Insert the provided **tamper-resistant bolt (L)** through the washer (**M**) and the traffic control device and into the **threaded insert (N)** on the Parakeet and tighten with the provided **tool (O)**.

**STEP 2**

Place the mounted Parakeet in the work zone where it will be stationed. **NOTE:** Ensure there is an area that is free of moving objects in front of the unit as much as possible. This ensures that the unit has an unobstructed path for calibration of the ultrasonic sensor.

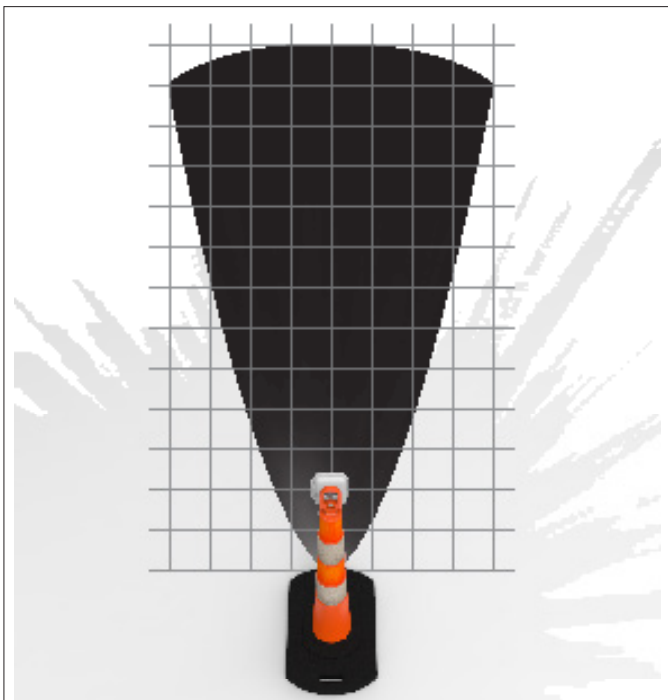
**STEP 3**

Open the unit and slide the **power switch (F)** up into the ON position.

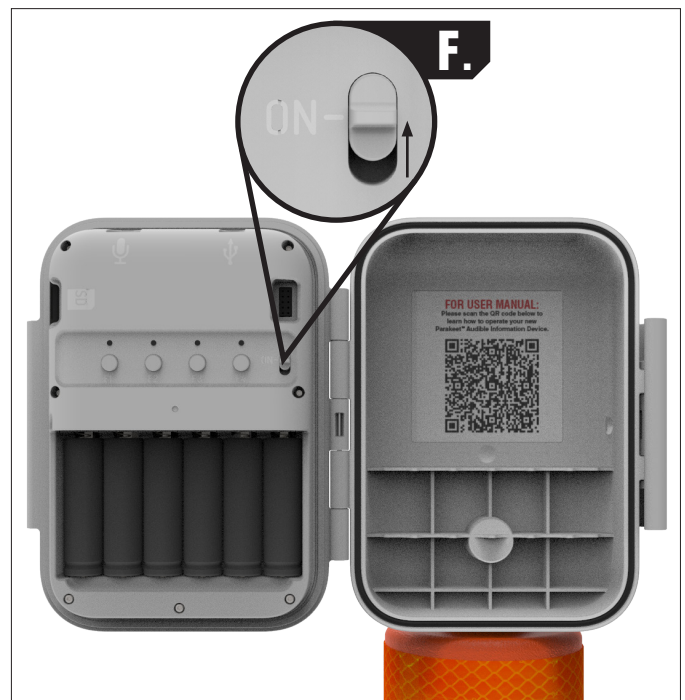

STEP 4

Wait approximately 4-5 seconds for the 4 LED lights to flash amber once then green. The F1 light will then begin flashing green. The Parakeet is working from its previous calibration. PSS recommends recalibrating the Parakeet.



NOTE: The Parakeet comes with a base message of "Congratulations on activating your new Parakeet audible information device by PSS. For instructions on programming the device, please consult the Parakeet manual by scanning the QR code on the inside of the Parakeet housing.". If a different message is desired, see section 7 to record a message locally.

STEP 1

To enter the calibration mode, press the **F1 button (P)**. When the unit enters calibration mode, the LED light above the F1 button will flash red. Press the F1 button again and the F1 light will flash amber.

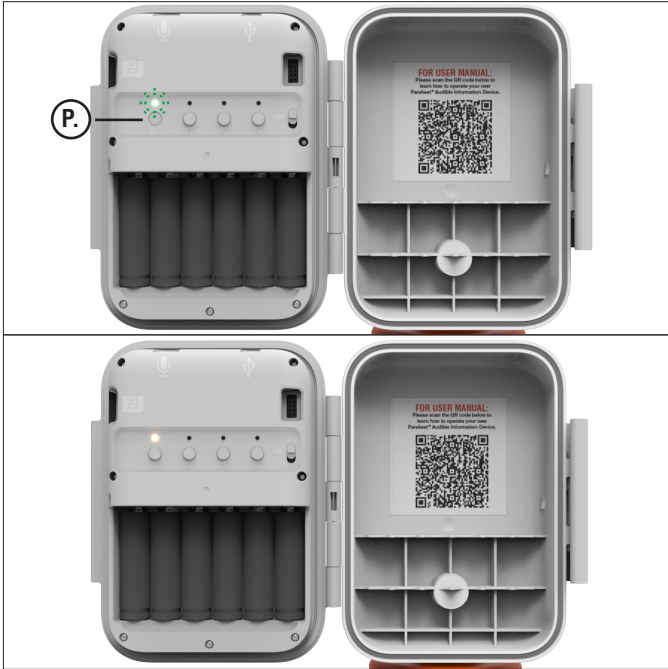
**STEP 2**

Once the F1 amber light is flashing, close the Parakeet housing unit immediately and stand behind the device to allow for a clear path of sensor detection, free of moving objects and pedestrians. Depending on the surrounding area and noise level, calibration will take between 10-30 seconds to complete.

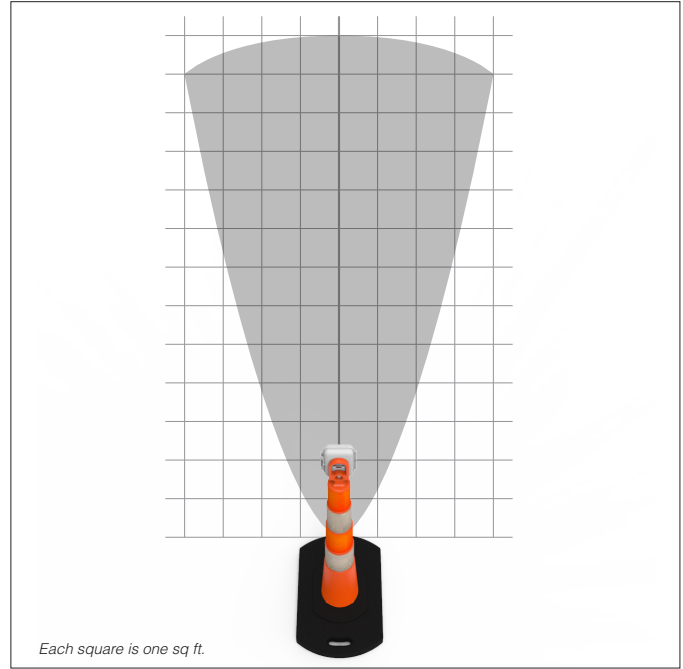
**STEP 3**

Once calibration is complete, the unit will play the message "calibration complete".

**STEP 4**

Once the Parakeet is calibrated, the unit should begin motion detection. To double check, open the unit and check that the LED light above the **F1 button (P)** is flashing green.



Sect. 04 BASE VOLUME ADJUSTMENT

NOTE: Parakeet will play at a level 5db above surrounding noise levels, with a base volume pre-set as the lowest level. To adjust the base volume, follow the instructions below.

STEP 1

Press the **F2 button (Q)** to enter volume adjustment mode. This mode will cause the main audio to continuously play, allowing you to adjust the volume accordingly using the **F3 and F4 buttons (R and S)**. As audio is being played the LED above the F2 button will continuously flash red.

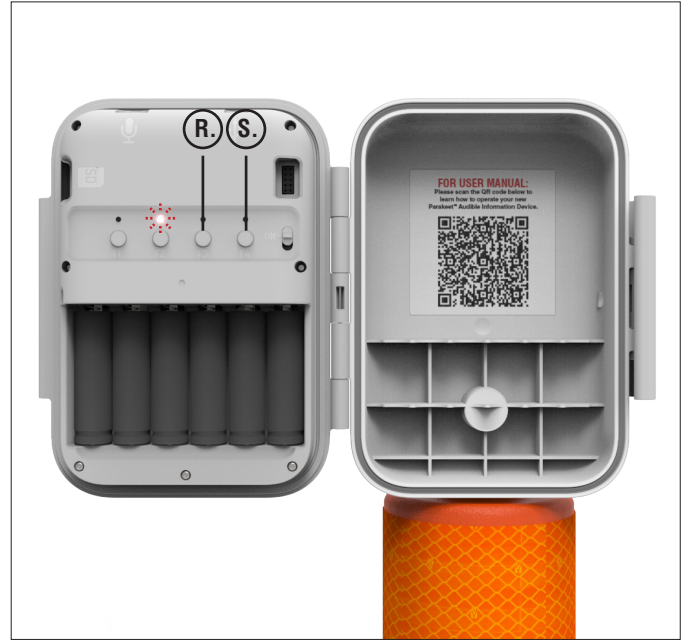

STEP 2

Pressing the **F3 button (R)** will increase the volume, and the **F4 button (S)** will decrease the volume. The LED light above the F3 and F4 buttons will flash green when pressed.

NOTE: If the F3 or F4 buttons are pressed before entering the volume adjustment mode, the volume will not change.



STEP 3

When you are satisfied with the base audio level, press the **F2 button (Q)** to exit volume adjustment mode. **NOTE:** Parakeet will auto-adjust to be louder than the ambient noise but no lower than the base volume set by the user.

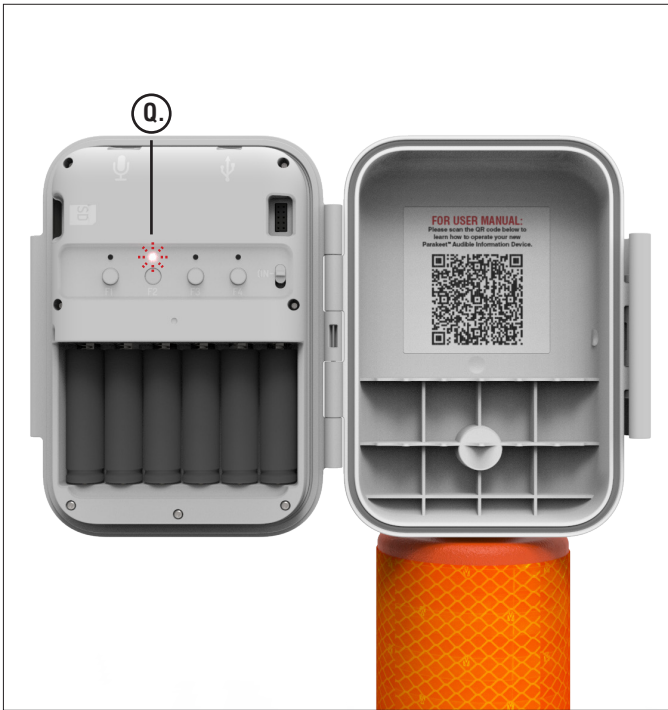
**STEP 4**

Press and hold the **F1 button (P)** for four seconds to resume detecting from the previous calibration. PSS recommends recalibrating your Parakeet after adjusting the volume. For more information on the calibration process, see section 3.

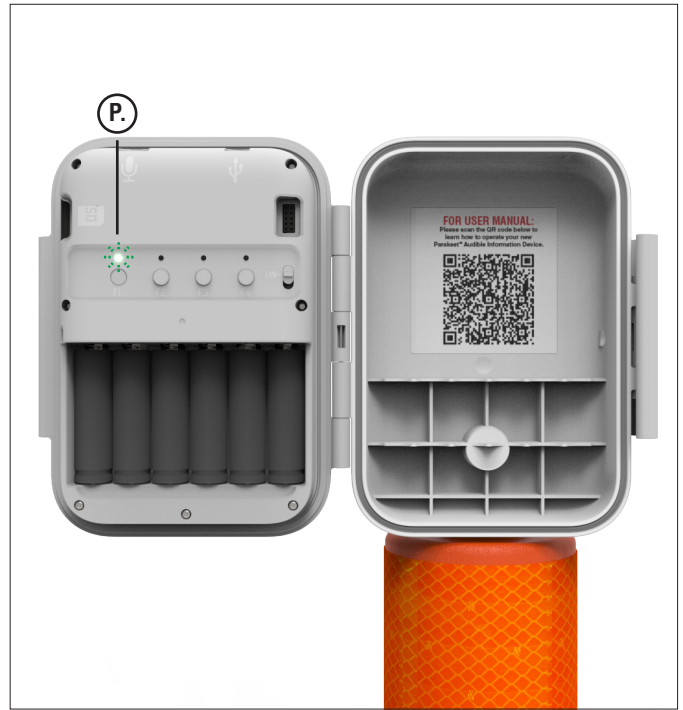

STEP 1

In the event that you have repeated authorized motion in front of the Parakeet, users may elect to pause the Parakeet. To pause the functionality of your Parakeet without turning the power off, press the **F1 button (P)** once. The F1 LED will flash red. In this mode, the Parakeet will not play a message.

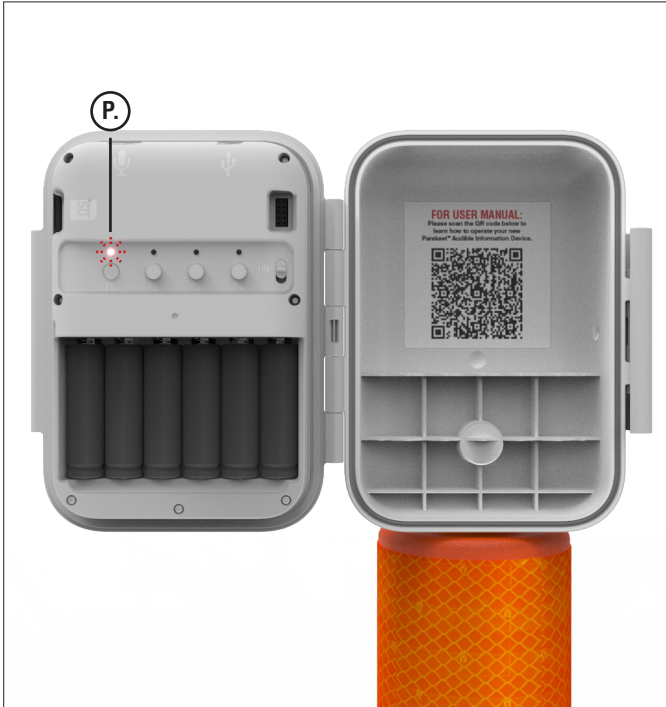
**STEP 2**

Once you are done in this mode, PSS recommends recalibrating your Parakeet. For more information on the calibration process, see section 3.

To resume from a previous calibration state, press and hold the **F1 button (P)** for four seconds. The F1 LED will begin flashing green.



STEP 1

To check the battery life of your Parakeet, press and hold the **F2 button (Q)** for four seconds. The F4 LED will flash in increments of 10%. When the battery life is at 50% or lower, the F4 LED will flash red a corresponding amount of times. If the battery life is 60% or above, the F4 LED will flash green a corresponding amount of times. For example: If the battery indication process was initiated by the user and the F4 LED flashes red four times, the battery life is at 40%. Or if the battery indication process was initiated by the user and the F4 LED flashes seven times, the battery life is at 70%.



BATTERY PERCENTAGES

NUMBER OF FLASHES	1	2	3	4	5	6	7	8	9	10
BATTERY PERCENTAGES	10%	20%	30%	40%	50%	60%	70%	80%	90%	100%



NOTE: Some states have specified the use of text to speech recordings and/or standardized messaging on AIDs. Defer to your local agency's standards. For optimal message clarity, PSS recommends using text-to-speech message recordings. For on-site reprogramming of the SD Card, refer to the Parakeet Manual or click [here](#). Quality of local device recordings can vary greatly based on microphone used, background noise, individual voice of person recording, and other factors. For optimal local recording message clarity, record your message indoors or in a quiet location. Microphone is not included.

STEP 1

Plug the **microphone (T)** into the **3.5 mm microphone jack (U)** on the top of the open unit.

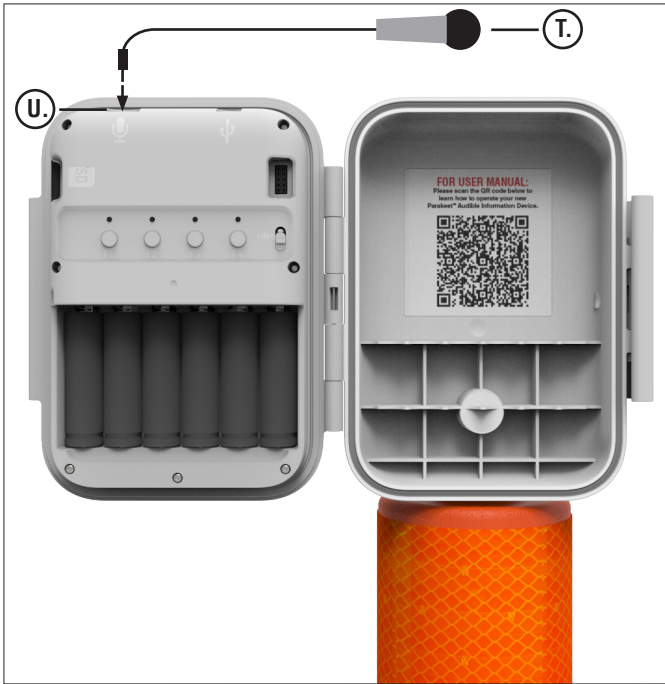

STEP 2

Slide the **power switch (F)** upwards to turn the Parakeet on. Press the **F1 Button (P)**. The LED light above will flash red.

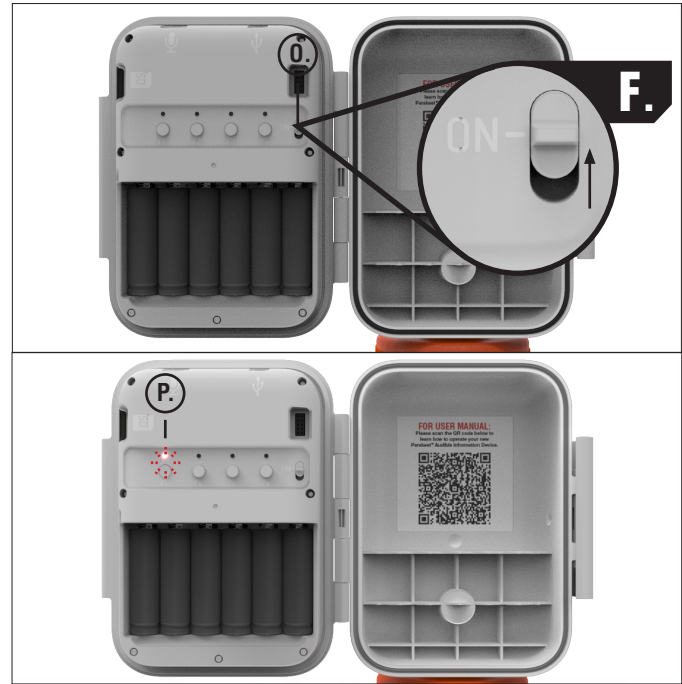

STEP 3

Press and hold the **F3 and F4 buttons (R and S)** simultaneously and wait for all LEDs to turn a steady red. Start speaking clearly and audibly into the **microphone (T)**.



STEP 4

Once you are done recording your message, press the **F4 button (S)** to stop recording.

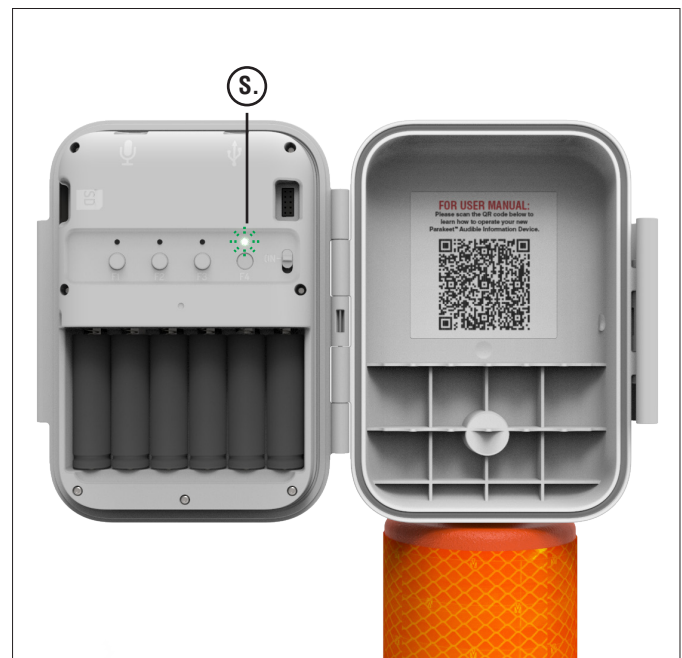

STEP 5

Parakeet will play the message back and the F1 LED will flash red.

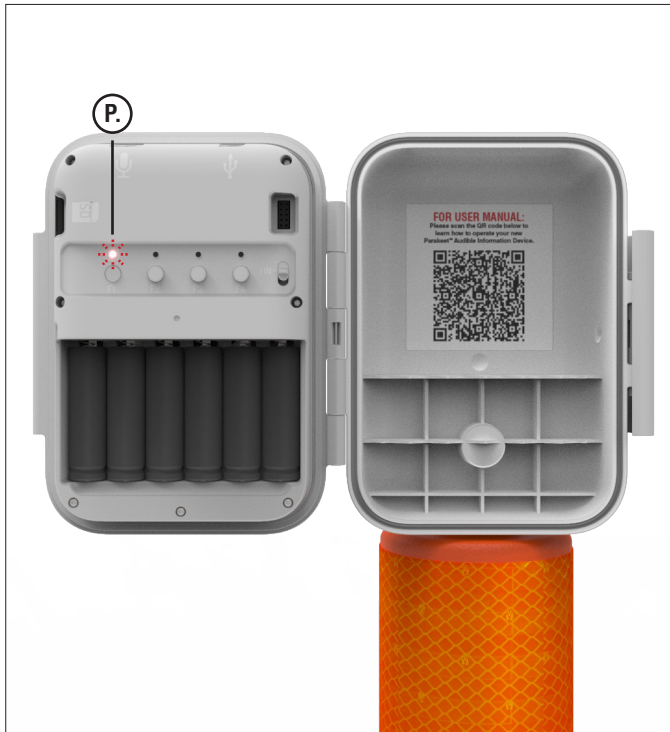

STEP 6

If you wish to rerecord your message, press and hold the **F3** and **F4** buttons (**R** and **S**) simultaneously.

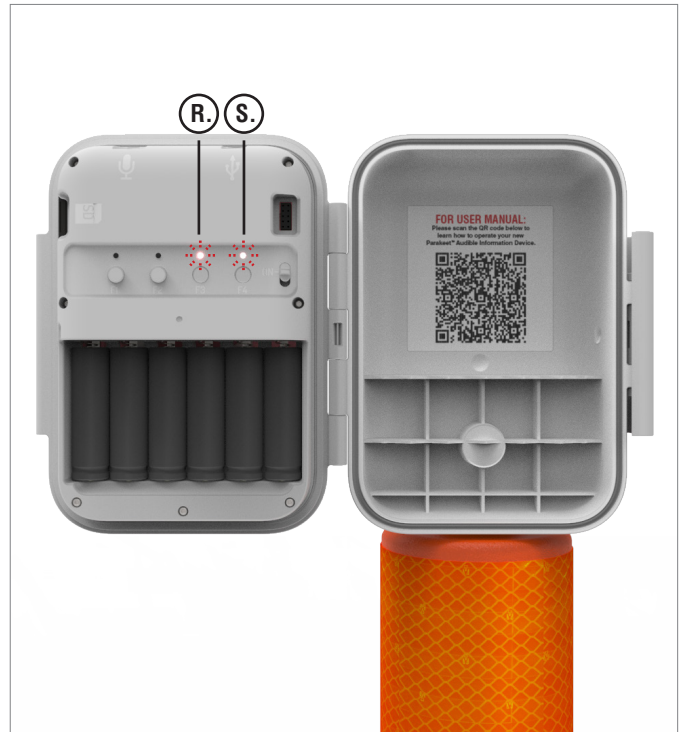

STEP 7

Once you are satisfied with your recording, press the **F1** button (**P**) to save the recording and recalibrate the Parakeet. The F1 LED will flash red.

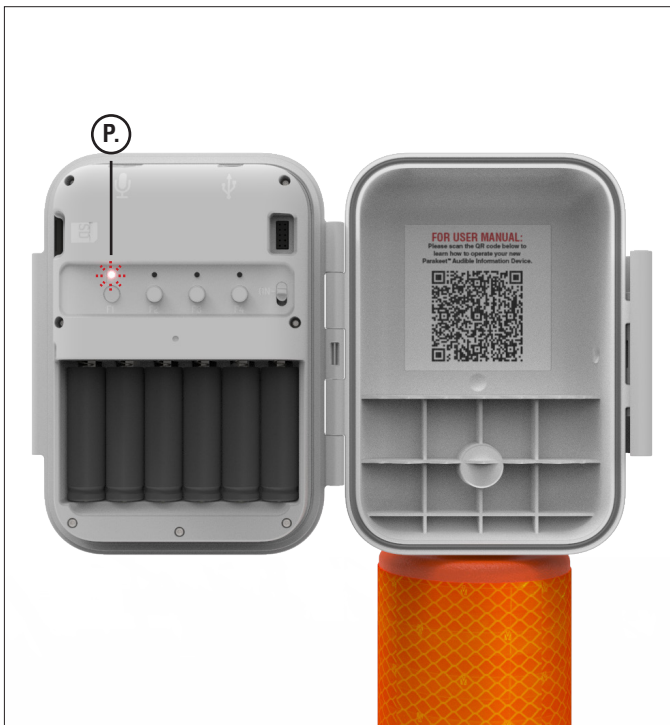



SIDEWALK CLOSED
→
CROSS HERE

SEE OTHER NO. Q11518
800-662-6338
PSS-Innovations.com



CONTACT:

Call 800-662-6338 to talk to a Customer Service Representative.

HOURS:

8 AM to 5 PM (E.T.)
Monday through Friday

Follow us on:



Innovations for Safety™