



FULL PRODUCT GUIDE

Expertly designed traffic safety devices



CONTACT:

Call 800-662-6338 to talk to a Customer Service Representative.
2444 Baldwin Road, Cleveland, OH 44104 | PSS-Innovations.com

HOURS:

8 AM to 5 PM (ET) Monday through Friday

Follow us on:



SCAN TO VIEW
OUR ENTIRE
CATALOG ONLINE



TABLE OF CONTENTS

PAGE
02 | WHO WE ARE

PAGE
03 | SECTION 1
ROADQUAKE™
SAFETY SYSTEM

PAGE
10 | SECTION 2
RIGHTPATH™ ADA-
COMPLIANT DEVICES

PAGE
16 | SECTION 3
CRASH CUSHIONS,
DRUMS & CHANNELIZERS

PAGE
18 | SECTION 4
BARRICADES & WAVE™
CENTERBOARDS

PAGE
21 | SECTION 5
TRAFFIC SAFETY
EQUIPMENT

WHO WE ARE

WE ARE PSS:

Since 1982, PSS has engineered breakthrough solutions that help safeguard worksites and save lives.

Over the past forty years, the world has evolved significantly, from the enactment of the Americans with Disabilities Act to the widespread use of cell phones, which have brought both advancements as well as challenges. Throughout this time, PSS has remained committed to adapting and addressing the evolving demands of an ever-changing world.

Despite these changes, our focus has remained on the right-of-way — that point in time and place where motorists, workers, and pedestrians inevitably intersect and interact. Our goal is to design products and services that provide safe travels so that everyone can return home safely at the end of the day.

We don't just talk about Innovations for Safety™ — we live it. We believe that bold ideas and hard work produce outstanding results.

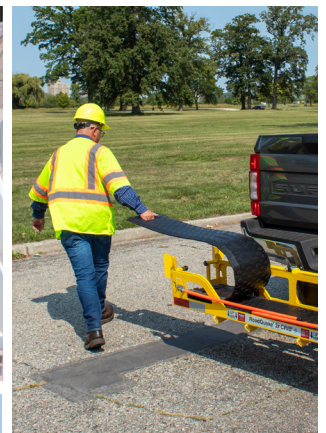
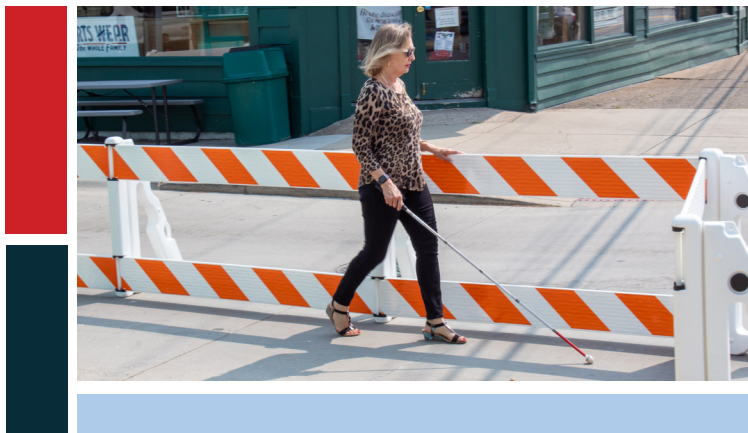

ROADQUAKE TPRS APPLICATIONS:

Nearly two decades of field evidence have demonstrated that RQ2F effectively alerts distracted drivers, helping to reduce work zone intrusions and save lives.

On any given day, RoadQuake™ 2F is used in many two-lane flagging operations and multi-lane projects across the country. This application is now a commonly implemented safety countermeasure by most State Departments of Transportation.

EXPANDED RQ2F APPLICATIONS:

With RQ2F's expanded use, PSS has developed supporting devices to allow for RQ2F application in high-speed, high-volume, multi-lane closures.

RAPTOR™ rumble strip handling machine, and the Rover™ RAPTOR trailer further protect workers by reducing their exposure to live traffic during deployment and retrieval of RQ2F.

Please visit pss-innovations.com/our-team to contact your PSS Regional Manager for a product demonstration.

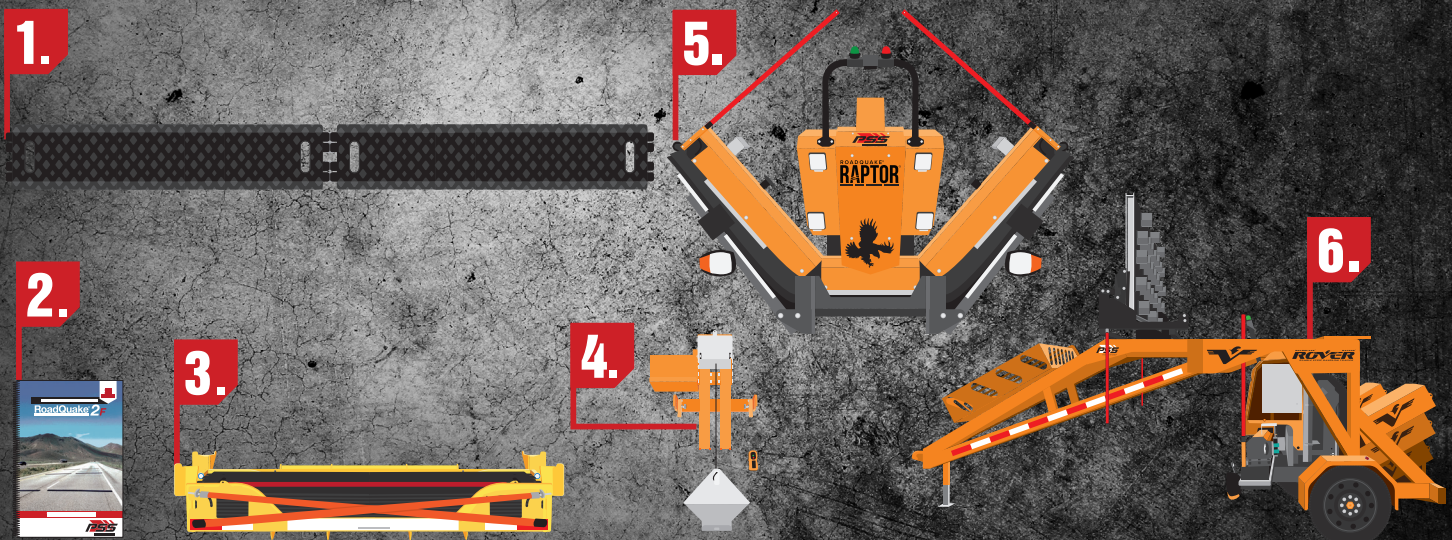
**ROADQUAKE™ SAFETY SYSTEM:**

- 1. RoadQuake 2F Temporary Portable Rumble Strip (RQ2F):** The fundamental component of the RoadQuake Safety System alerts distracted drivers to changing road conditions, including work zones.
- 2. RoadQuake Best Practices Guide:** The official manual on proper RQ2F usage for optimal performance.
- 3. CRIB™ RQ2F Carriers:** A series of vehicle-mounted cargo carriers specifically designed to transport, deploy and retrieve RQ2F in rumble strip operations. CRIB includes T-Handle, a handheld accessory to aid in the manual lifting of RQ2F.
- 4. RoadQuake 2F Retrieval System:** An automated winch designed to pull RQ strips from the road, back into the CRIB carrier, reducing worker exposure.
- 5. RAPTOR:** An automated handling machine to remotely deploy, retrieve, and realign RQ2F from the safety of a vehicle cab. RAPTOR mounts to the front of a vehicle with a front-end capacity of at least 3,000 lbs.
- 6. RAPTOR Rover:** An operational trailer designed for RAPTOR, towable by trucks with a half-ton or greater towing capacity, enhancing fleet compatibility.

TEMPORARY:

- » Ideal for short duration work zones where daily installation and removal is required
- » Requires no adhesives or fasteners



DURABLE:

- » Three to seven year lifespan under typical conditions
- » Suitable for use in the rain and in temperatures as low as 0° F (-18° C) and as high as 180° F (82° C)
- » Approved for posted speed limits up to 80 MPH
- » Three-year prorated limited warranty



EASE OF INSTALLATION:

- » Drag, drop, and go — one to two workers can manually deploy and/or retrieve in minutes
- » Optional RoadQuake accessories are available that allow for easier deployment and retrieval



ADDITIONAL ROADQUAKE 2F FEATURES:

- » RoadQuake 2F generates similar levels of sound and vibration as milled-in longitudinal rumble strips
- » Covers the entire width of a lane
- » Folds to 66" length for handling. Weighs 105 lbs.
- » Molded handles for easier lifting
- » Molded-in red stripe & "This Side Down" label on the bottom-side of strips indicate correct orientation for deployment
- » Non-slip textured surface helps to keep RoadQuake 2F TPRS in place
- » Bevels on leading and trailing edges allow motorcycles to traverse RQ2F safely
- » Meets Section 6M.06 of the 11th Edition MUTCD
- » Black, white and orange strips are available for usage in the United States. Other colors, such as yellow, are available to our customers outside the United States

Patents: <http://bit.ly/3cHVTp8>

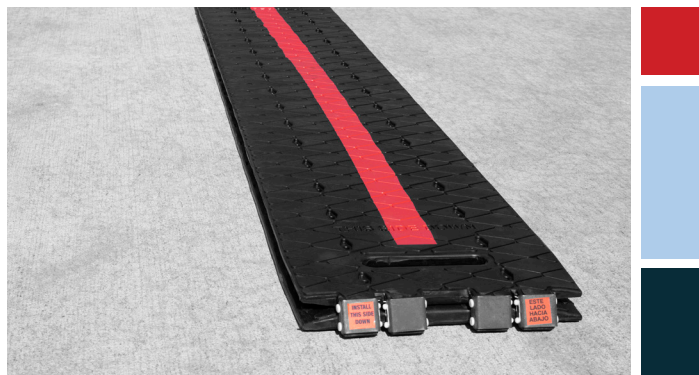
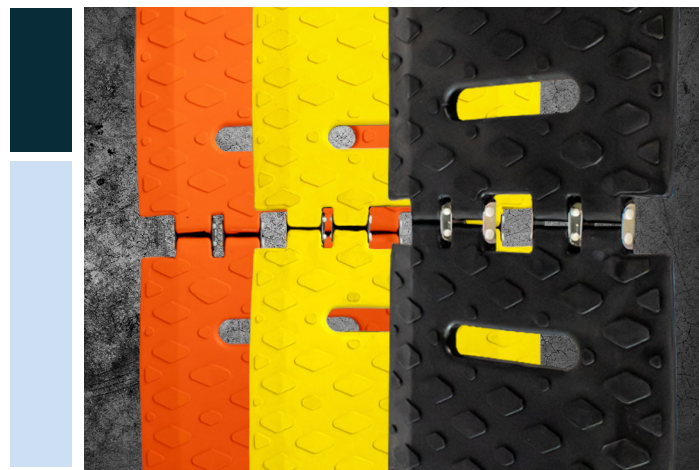

ROADQUAKE™ 2F CRIB™:

The CRIB is a cargo carrier designed for the transport, deployment, and retrieval of RoadQuake 2F, available in three sizes: CRIB-6 (holds 6 strips), CRIB-9 (holds 9 strips), and CRIB-12 (holds 12 strips) to account for rumble strip arrays in quantities of three.

CRIB reduces time spent in traffic by enabling one-person deployment and retrieval of strips, mounts externally on the vehicle to save interior space, and ensures easier, more aligned placement of RQ2F without the need for inverted installation.

CRIB FEATURES:

- 1. Guide Fins*:** Corner plates that guide RoadQuake 2F in and out of CRIB for easier handling.
- 2. Guide Markers:** Attached bumper guides provide visual queues when the vehicle is in reverse.
- 3. T-Handle Holder:** CRIB stores and transports two RoadQuake T-Handles, which allow for easier lifting of RQ2F.
- 4. Quik-Detach Mounting System:** Expedites the removal and installation of the CRIB Carrier.
- 5. Retractable Ratchet Straps:** Straps that extend from the attached housing to secure RQ2F strips during transport.
- 6. Literature Canister:** A water-tight canister holds a print copy of our RQ2F Best Practices Guide and a breakaway pin connection replacement kit.
- 7. Roller Bearings:** Allow for easier retrieval and deployment of RQ2F in and out of the CRIB.
- 8. "Lift Here" Labels:** Decals on the front of CRIB indicating proper fork placement for forklift transport.



**New CRIB models do not stack with older models*

***Quik Detach for CRIB-6 (black) works for CRIB-6 and CRIB-12. Quik Detach for CRIB-9 (blue) works for CRIB-9*

CRIB front label features a QR link to RQ2F instructions

Patents: <http://bit.ly/3cHVTp8>

CRIB-6 FRONT

We use the CRIB-6 below to show our design features, CRIB-9 and CRIB-12 also enjoy the same features.

**CRIB-6 BACK**

	CRIB-6	CRIB-9	CRIB-12
			
Dimensions (WxHxL)	19 5/8" x 15" x 74 1/4"	19 5/8" x 19 9/16" x 74 1/4"	19 5/8" x 24 5/16" x 74 1/4"
Materials	Yellow Powder Coated Steel	Blue Powder Coated Steel	Black Powder Coated Steel
TPRS Capacity	6	9	12
Weight (Empty)	92 lbs. (41 kg)	111 lbs. (50 kg)	133 lbs. (60 kg)
TPRS Weight	630 lbs. (286 kg)	945 lbs. (429 kg)	1,260 lbs. (572 kg)
Total Weight (TPRS & Carrier)	722 lbs. (327 kg)	1,056 lbs. (479 kg)	1,393 lbs. (632 kg)
Mounting / Receiver	Class IV or V	Class V, or Custom by User	Custom by User
Pintle Mount	Included (2")	Included (2 1/2")	Not Included
Quik-Detach	1 Each Included (Black) 	1 Each Included (Blue) 	2 Each Included (Black) 
Roadquake™ T-Handle	2 Each Included	2 Each Included	2 Each Included
T-Handle Holder	1 Each Included	1 Each Included	1 Each Included
Retractable Transport Straps	2 Each Included	2 Each Included	2 Each Included
Conspicuity Tape	3 Sides Included	3 Sides Included	3 Sides Included
Guide Markers	36" Included (91 cm)	48" Included (122 cm)	48" Included (122 cm)
Literature Cannister	1 Each Included	1 Each Included	1 Each Included
RoadQuake Best Practices	1 Each Included	1 Each Included	1 Each Included
Breakaway Pin Kit (1 TPRS)	1 Each Included	1 Each Included	1 Each Included
Max Stack (loaded)	4	3	2

NOTICE:

**UNDERSTAND THE CAPACITIES AND CAPABILITIES OF
YOUR VEHICLE PRIOR TO MOUNTING CRIB**



RETRIEVAL SYSTEM FEATURES:

Designed as an additional option for use with CRIB™, RoadQuake™ 2F Retrieval System is a motorized winch designed to retrieve strips from the road, **reducing worker exposure and making retrieval a one-person job.**

- » Features a powerful 4.1 HP, 12 V electric motor that pulls a 105 lb. RQ2F into CRIB in less than ten seconds.
- » Attaches quickly to either end of CRIB for retrieval of strips from either driver or passenger side.
- » Power pack unit is a self-contained, charging electrical system. It charges from a 12-Volt automotive system. and maintains charge when plugged into running host vehicle. Power pack unit is weather-resistant.

Patents: <http://bit.ly/3cHVTp8>

**RETRIEVAL SYSTEM****RETRIEVAL SYSTEM COMPONENTS**

1. Retrieval Plate
2. Retrieval Winch
3. Retrieval Rope (30 Feet)
4. Power Pack Unit
5. Power Pack Charger
6. Back-up Wired Controller
7. Wireless Remote Controller
8. Roller Bracket Assembly (Two Each)
9. Roller Bracket Clamps (Four Each)
10. Durable Pelican™ Case



RAPTOR™ TPRS HANDLING MACHINE:

RAPTOR is an automated handling machine that transports, deploys, realigns, and retrieves RoadQuake 2F in work zones while keeping workers off the road.

The machine eliminates the need for workers to manually lift RQ2F and deploys a three strip array in less than 90 seconds.

**RAPTOR IMPROVES WORK ZONE SAFETY:**

RoadQuake allows for expanded application of RQ2F, making it ideal for most short-duration, moving, and mobile work zones.

RAPTOR mounts to the front of vehicles with at least 3,000 lb. front axle capacity. The back of the vehicle is free for other safety equipment, such as a Truck/Trailer Mounted Attenuator (TMA) and/or a flashing arrow board.

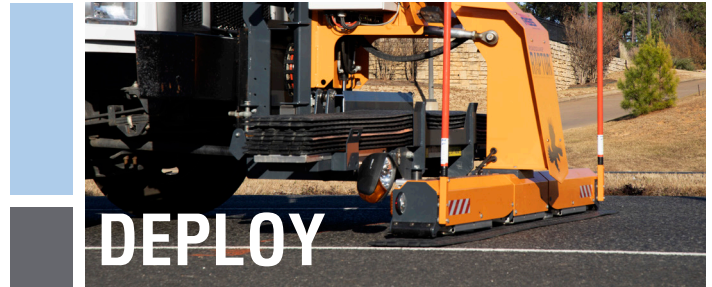
**TRANSPORT MODE:**

1. TPRS Tray
2. TPRS 0-12 Strips
3. Folding Guide Marker
4. Auxiliary Headlights
5. Work Lights

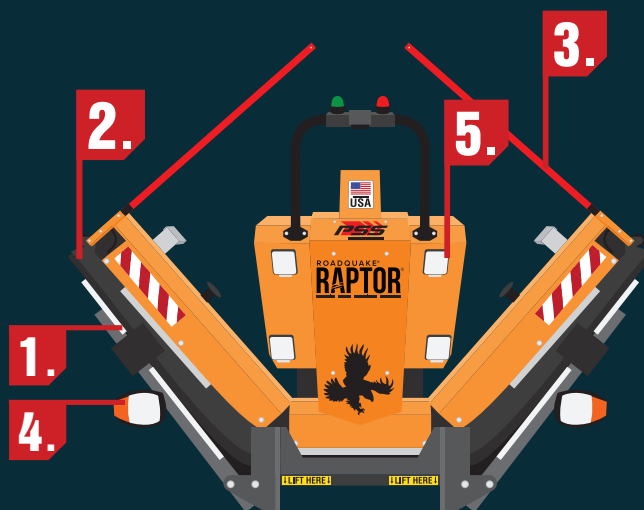
**OPERATIONAL MODE:**

1. Forklift Support 30" Wide
2. Position Lamps
3. RoadQuake™ 2F TPRS
4. Indicator Lights
5. Forward-Facing Camera
6. Magnet Bar
7. Positioning / Alignment Rod

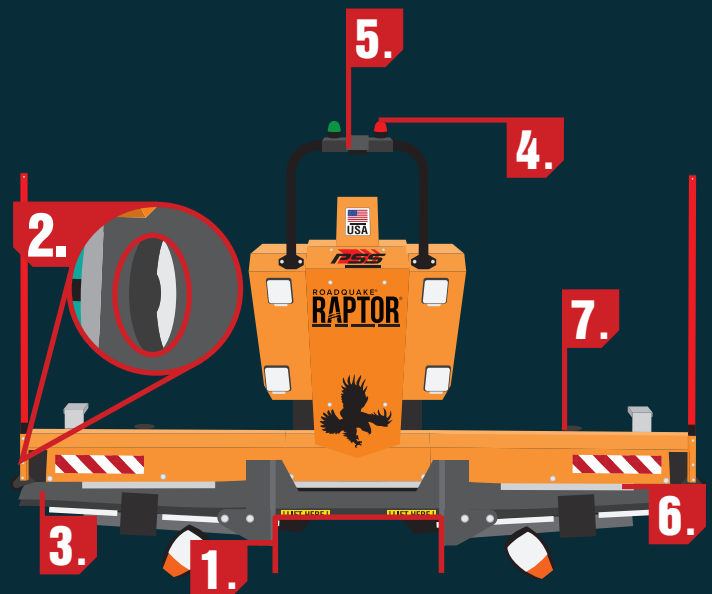

*To understand all of the functions of RAPTOR, please review the RAPTOR Instruction Manual.

Patents: <http://bit.ly/3cHVTp8>

RAPTOR™ ROVER™ RUMBLE STRIP HANDLING TRAILER:

The introduction of RAPTOR Rumble Strip Handling Machine revolutionized the deployment, realignment, and retrieval of RoadQuake™ 2F Temporary Portable Rumble Strips (TPRS). By keeping workers out of live traffic, the use of RoadQuake TPRS became easier and safer than ever before.

PSS now introduces the RAPTOR Rover to expand fleet compatibility. Instead of requiring a 3,000 lb. front-end capacity truck, **Rover is towable by vehicles with a half-ton or greater towing capacity.***

Rover is designed specifically for the transport of RAPTOR and hitches to the back of the operating vehicle. RAPTORs mounted on Rover use the same remote control and monitor feed functions as the original RAPTOR.

With RAPTOR Rover, more work vehicles are now compatible for automated TPRS use, protecting your crew and making their work more efficient.

**Rovers with optional arrowboard attached will need 800 lb tongue weight capacity. If your vehicle can tow 800 lbs. of tongue weight and a tow weight of 5,000 lbs*

Patents: <http://bit.ly/3cHVTp8>

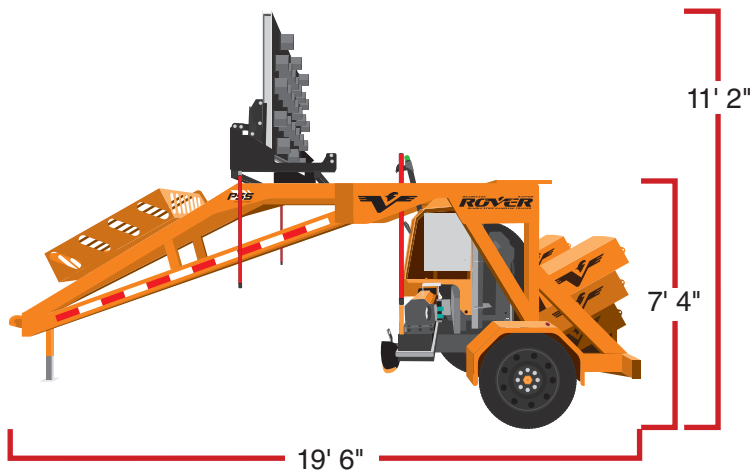
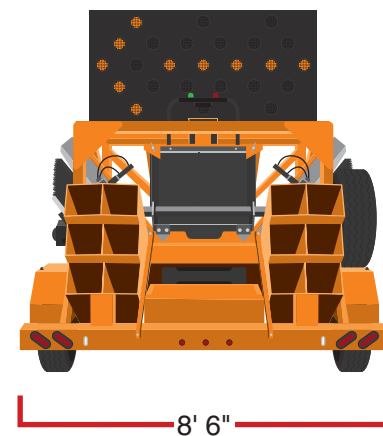

RAPTOR™ ROVER™ DIMENSIONS

RAPTOR ROVER DIMENSIONS (SIDE VIEW):**RAPTOR ROVER DIMENSIONS (REAR VIEW):****RAPTOR ROVER SPECIFICATIONS:**

- » Designed exclusively for the transport, deployment and retrieval of RoadQuake 2F TPRS
- » There is no change to RAPTOR functions
- » Single Axle Capacity: ~7,000 lbs.
- » Towing weight: ~4,960 lbs. (including loaded RAPTOR)
- » Tongue weight: 500 lbs. (without optional arrowboard) / 800 lbs. (with optional arrowboard) dependent on configuration
- » On-board battery bank
- » Batteries may be charged by solar panel and trailer plug
- » Arrow board optional

TEMPORARY PEDESTRIAN MODULAR RAMP:

BoardWalk RAMP provides accessible, detectable, and safe guidance where temporary access routes cross curbs at locations other than permanent sidewalk crossings. BoardWalk RAMP is installed perpendicular to the curb, replacing non-compliant curb transitions and temporary ramps.

BOARDWALK RAMP FEATURES AND BENEFITS:

- » Provides 1" rise per 12" run for **any curb height**
- » Modular edge support castings provide guidance for canes and walkers. Castings accommodate handrail assemblies, which provide **detectable guidance**
- » Provided lumber has a **slip-resistant surface**
- » Innovative design allows for normal **water drainage**
- » Slip-resistant ramp & approach plates are 48" wide to **accommodate wheelchair access**
- » Modular sections allow for **adjustable ramp length**
BoardWalk RAMP is rated at **800 lb. capacity**
Individual BoardWalk RAMP sections weight 30 lbs. each
- » Modular cast-iron edge support castings measure 8" x 12"
- » Optional handrail attachment

Patents: <http://bit.ly/3cHVTp8>

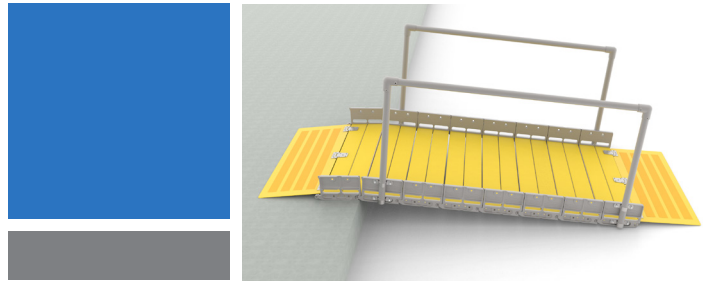
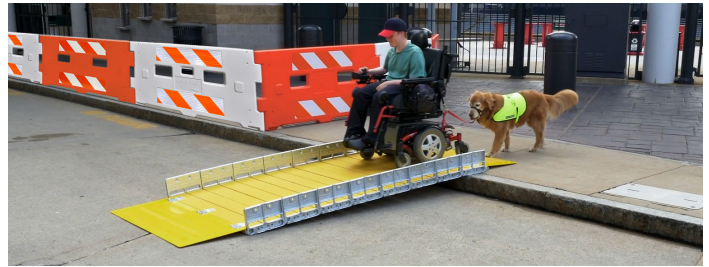
**BOARDWALK PLATFORM****BOARDWALK BI-DIRECTIONAL PLATFORM:**

BoardWalk Bi-Directional Platform is designed for use with BoardWalk RAMP when the alternate pedestrian pathway is parallel to the curb or sidewalk.

PLATFORM FEATURES:

- » BoardWalk Platform measures 4' x 5' to accommodate **wheelchair access**
- » Four adjustable screw jacks support the Platform, and can accommodate **curb heights from 2" to 14"**
- » For RAMPs exceeding nine sections, midway support is required (see page 11)
- » The Platform is **easily converted from left-turning to right-turning orientation**. To change the guiding direction, attach the movable detectable edge and the horizontal handrail to the corresponding side (see Figure A)
- » Figure B shows BoardWalk RAMP with Bi-Directional Platform installed in the curb lane **parallel to the sidewalk**. The curb lane serves as the temporary pedestrian pathway. The RAMP and the Platform are installed at either end of the sidewalk closure
- » Optional handrail attachment available

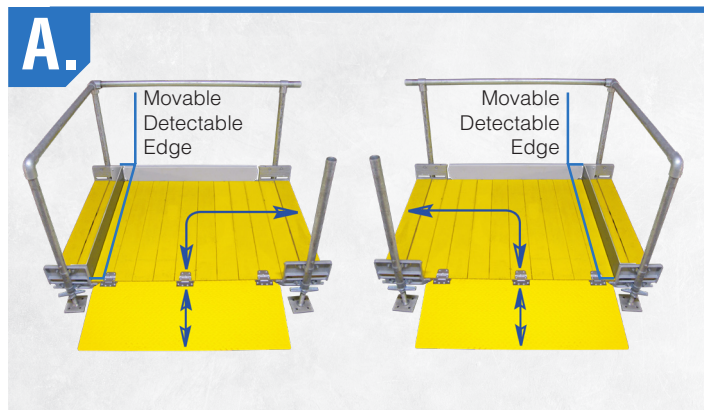

RAMP HEIGHT SPECIFICATIONS:

An ADA-compliant ramp should have a slope of 1:12, meaning for every inch of height, there should be 12 inches of ramp length to ensure accessibility and safety.

The number of modular ramp sections determines the slope of BoardWalk RAMP. The number of sections differs when using BoardWalk RAMP or BoardWalk RAMP and Platform. To determine the correct number of ramp sections for either BoardWalk RAMP or RAMP with Platform:

- » Which orientation of ramp do you require?
- » What is the height of the curb at the installation site?



Perpendicular to Curb



Parallel to Curb

To maintain a 1:12 ratio, how many RAMP sections are needed?

Curb Height (In.)	Perpendicular	Parallel
1	3	N/A
2	4	3
3	5	3
4	6	3
5	7	4
6	8	5
7	9	6
8	10*	7
9	11*	8
10	12*	9
11	13*	10*
12	14*	11*
13	15*	12*

* Midway supports required for RAMPs longer than nine sections.

RIGHTPATH™ SYSTEM**SIDEWALK CLOSURE COMPONENTS:**

In typical mid-block sidewalk closures, the curb lane is closed to vehicular traffic and used as a temporary pedestrian pathway. Pedestrians leave the sidewalk at one end, traverse the temporary pathway around the closure, and return to the sidewalk.

1. **SafetyWall™** sidewalk closure features a "Sidewalk Closed" sign. SafetyWall also provides smooth hand trailing and detectable cane guidance.
2. **Parakeet™ Audible Information Device** broadcasts audible directions to pedestrians that are visually impaired.
3. **SafetyRail™** provides accessible, detectable, continuous guidance and separates pedestrians from the sidewalk construction and the traffic lane. BoardWalk System then returns pedestrians to the sidewalk.
4. **BoardWalk System**, located at both ends of the pathway, provides an accessible, detectable, continuous curb transition for pedestrians.

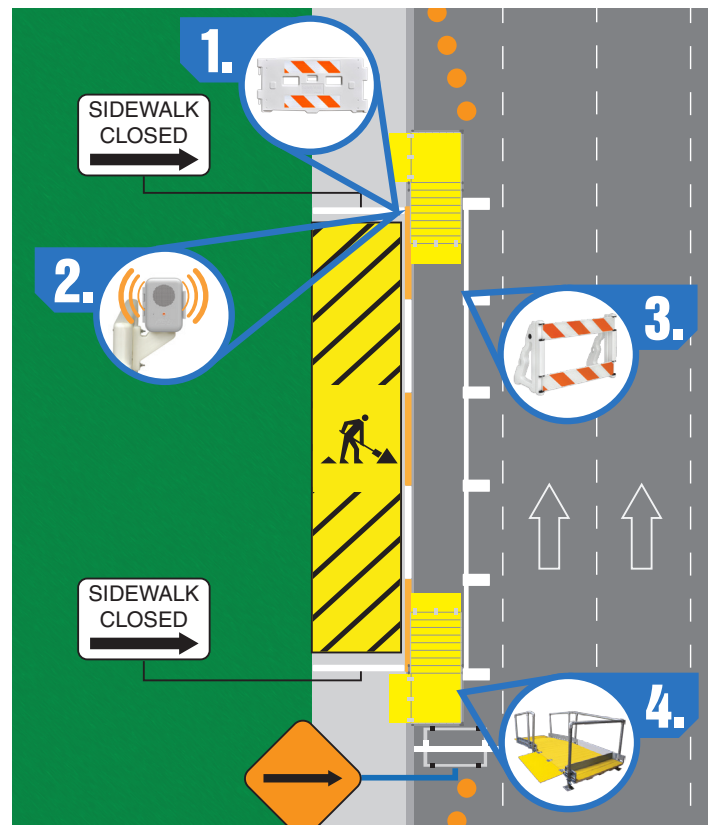

RAPIDRAMP™ THE EXPRESS ADA RAMP:

RapidRamp is a portable, ADA-Compliant ramp engineered with a lightweight design that reduces installation and removal time. Consisting of six sections that require no tools for assembly, RapidRamp may be installed on curbs up to 6" in height.

RapidRamp delivers an immediate solution to overcome vertical challenges, including accessibility around short-duration job sites and transportation of heavy loads with a cart or dolly. The device is designed to deliver a **firm, stable, and slip-resistant pathway over curb transitions.**

RAPIDRAMP FEATURES:

- » Ramp consists of six **slip-resistant surface** sections weighing approximately 22 lbs. each
- » Load capacity of up to 1,000 lbs., making it **suitable for both heavy equipment and wheelchairs**
- » End-sections with the slip resistant approach plate weighs 55 lbs.
- » Ramp sections are 48" wide in **compliance with ADA**
- » **Modular design** allows for installation of less than six sections if needed on a lower incline

Patents: <http://bit.ly/3cHVTp8>



RAPIDRAMP DIMENSIONS

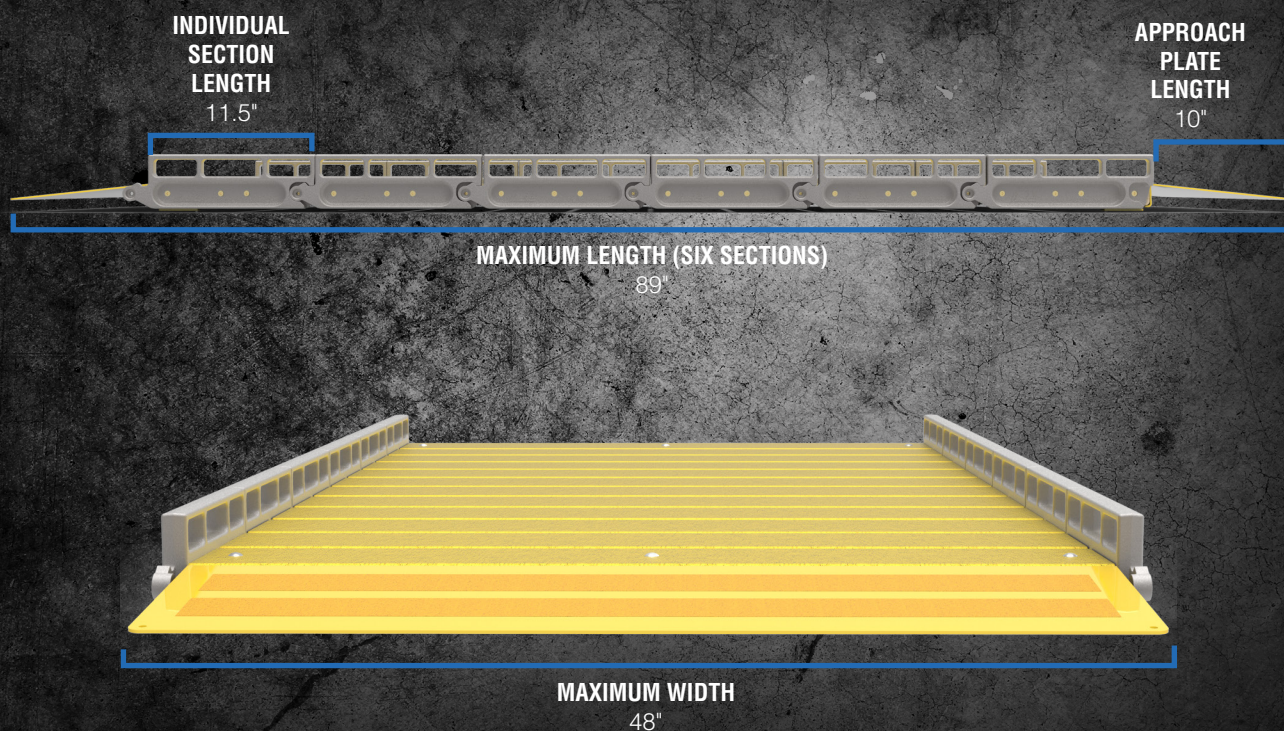

SAFETYWALL™ ADA-COMPLIANT BARRICADE:

SafetyWall is a continuous, interlocking barricade ideal for creating accessible work zones and meets ADA guidelines and is compliant with the 11th Edition of the MUTCD:

"When channelization is used to delineate a pedestrian pathway, a continuous detectable edging should be provided throughout the length of the facility such that pedestrians using a long cane can follow it. These detectable edgings should comply with the provisions of Section 6M.04."

SafetyWall provides **ADA-compliant** pedestrian guidance with **smooth hand trailing** as opposed to concrete or water-filled barriers, and is also **easier to transport, install, and remove**.

SafetyWall accepts retroreflective sheeting, meeting all ASTM D4956-19 specifications, on one or both sides.

**SAFETYWALL™ FEATURES:**

1. SafetyWall is an interlocking device that **assembles quickly, and requires no tools**, allowing a two-person crew to install an **accessible work zone in minutes**.
2. SafetyWall provides continuous guidance. Its hand-trailing top is smooth, **safer for hand guidance**.
3. It accepts audible information devices and warning lights.
4. The nesting feature provides **convenient storage**.
5. Steel legs fold in for easy storage. Recessed bottom edge allows for **easy deployment** of both legs.
6. Common vertical plane eliminates obstacles in the walkway for safer, **continuous guidance**.
7. Continuous bottom for guidance with canes. Gap between bottom of unit and ground is less than 2", **reducing potential for trapping cane tips**.
8. Centrally located carry handle allows for **easy transport** of one or two SafetyWall units.
9. Made from high-density polyethylene with UV inhibitors to **provide longevity and to prevent fading in the sun**

Dimensions: 3" W x 36.25" H x 74" L

Weight: 35 lbs.

Patents: <http://bit.ly/3cHVTp8>

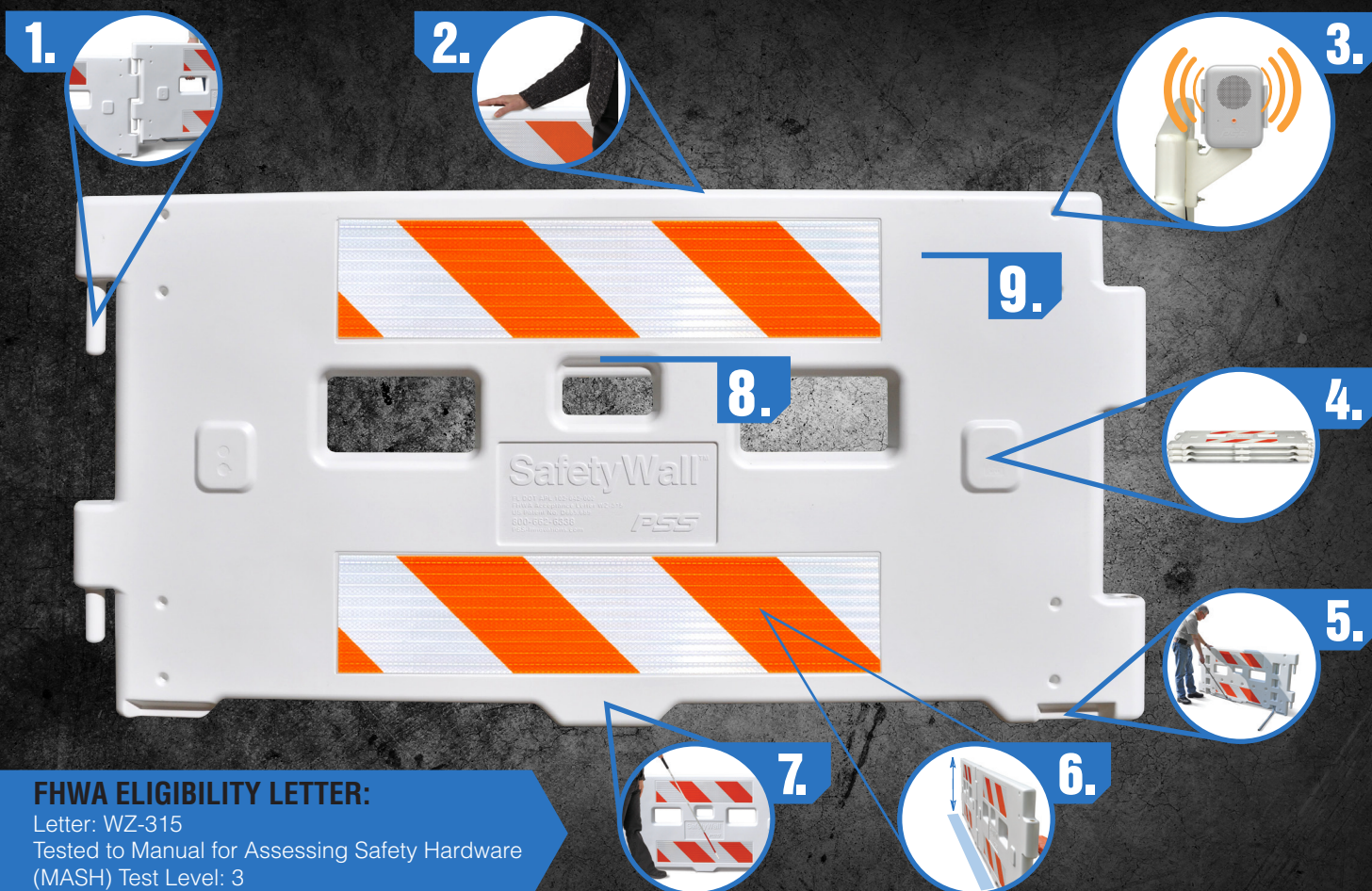
**FHWA ELIGIBILITY LETTER:**

Letter: WZ-315

Tested to Manual for Assessing Safety Hardware (MASH) Test Level: 3

SAFETYRAIL™ ADA-COMPLIANT BARRICADE:

SafetyRail is a continuous, interlocking device designed for creating accessible work zones. This device adheres to ADA guidelines and the 11th Edition of the MUTCD as a sidewalk closure barricade and longitudinal channelizer.

SafetyRail is designed for use with PSS Wave™ Guide Rail. The upper Wave Guide Rail is smooth, continuous, and safe for hand trailing. The lower Wave Guide Rail measures 1.5" from the ground, reducing potential for trapped cane tips. Made from high-density polyethylene with UV inhibitors, WaveGuideRail is available in four-foot or six-foot lengths with encapsulated ends eliminate cane or hand snagging hazards.

Wave Guide Rail accepts retroreflective sheeting, meeting all ASTM D4956-19 specifications, on one or both sides.



SAFETYRAIL FEATURES:

1. SafetyRail provides **continuous hand guidance** using the Wave™ Guide Rail.
2. Audible information device or warning light mount.
3. Oversized fill hole for **internal sand ballast**.
4. Top and bottom bushings hold Wave Guide Rail in place. **No installation tools required.**
5. Molded-in lug for **easy stacking**, also located by the fill hole and the molded handle.
6. Common vertical plane **eliminates obstacles** in the walkway for safer guidance.
7. Molded handle for **easy transport**.
8. Base support for optional ballast.
9. Measures 1.5" from ground, **reducing potential for trapping cane tips.**
10. Wave Rail "notch" design keeps guide rails securely in SafetyRail bushings.
11. Made with high-density polyethylene with UV stabilizers to provide **years of reliable service life.**

Dimensions: 3.25" W x 38" H x 24" L at base

Weight: 7 lbs. empty or up to 25 lbs. of ballast

Patents: <http://bit.ly/3cHVT8>

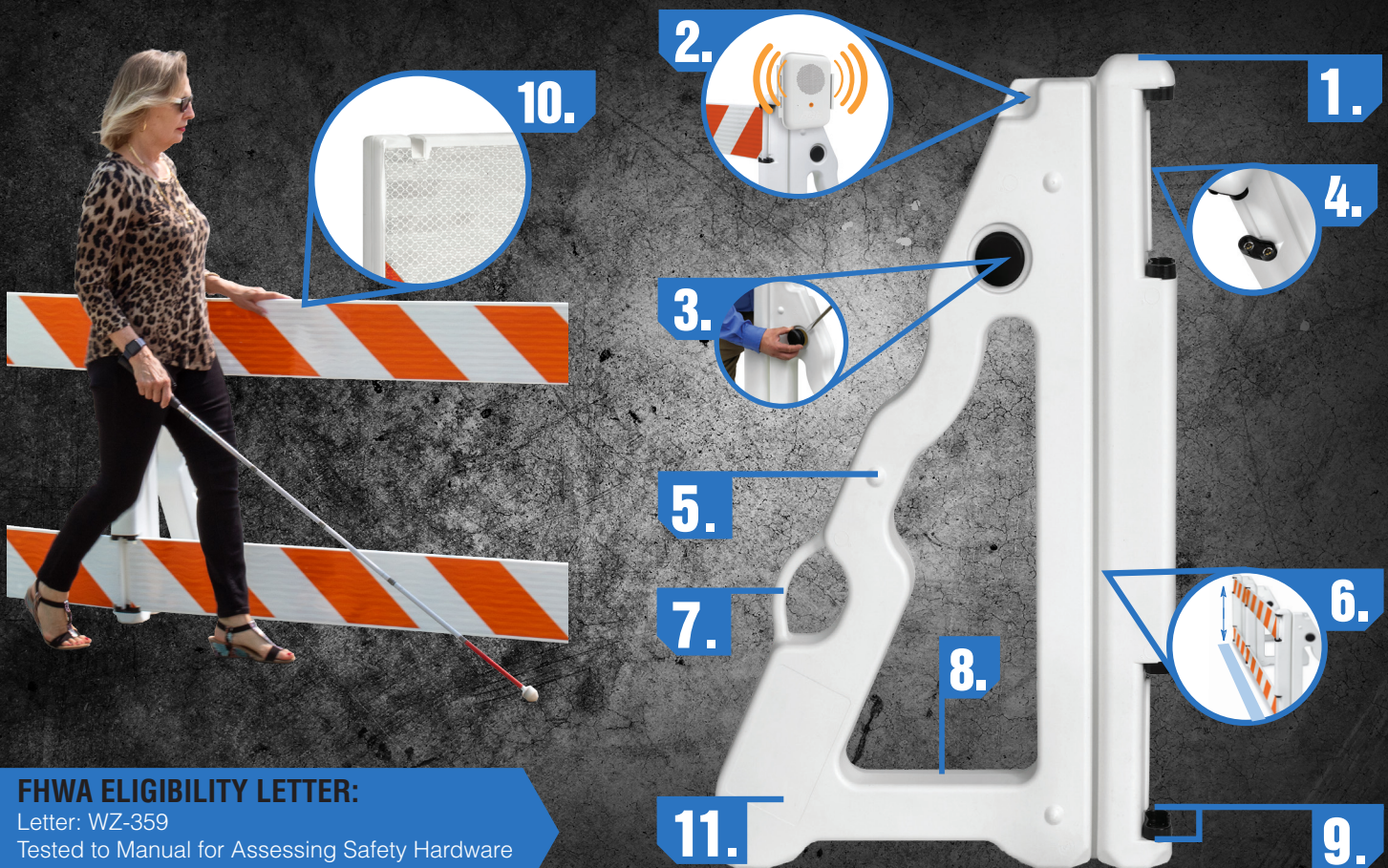

FHWA ELIGIBILITY LETTER:

Letter: WZ-359

Tested to Manual for Assessing Safety Hardware (MASH) Test Level: 3

PARAKEET™ AUDIBLE INFORMATION DEVICE (AID):

When work zones disrupt normal pedestrian pathways such as sidewalks, visual directions for alternative paths do not adequately communicate information to visually impaired pedestrians. Per MUTCD 11th Edition:

“Blocked routes, alternate crossings, and sign and signal information should be communicated to pedestrians with vision disabilities by providing devices such as audible information devices or barriers and channelizing devices that are detectable to the pedestrians traveling with the aid of a long cane or who have vision disabilities.”

The Parakeet™ is an AID designed for custom messaging with a built-in speaker and ambient microphone. Parakeet allows for up to 60-seconds of pre-recorded instructions to the alternate path for visually impaired pedestrians.

The device features smart motion detection responding only to pedestrians as they approach but not as they move laterally or away from the device to avoid false activation. Additionally, the built-in microphone automatically adjusts its decibel level based on surrounding noise throughout the day. Parakeet is designed for outdoor use only.

Patents: <http://bit.ly/3cHVT8>



PARAKEET FEATURES & BENEFITS:

- » Smart motion detection **prevents false activations and pedestrian confusion**
- » Automatic volume adjustment **matches ambient noise**
- » Up to 60-second recording
- » Mounts to standard traffic control devices
- » Rechargeable batteries and charger included
- » **Water-resistant housing**
- » Tamper-resistant casing and hardware **deters theft and vandalism**
- » Compatible with text-to-speech programs
- » Optional microphone not included

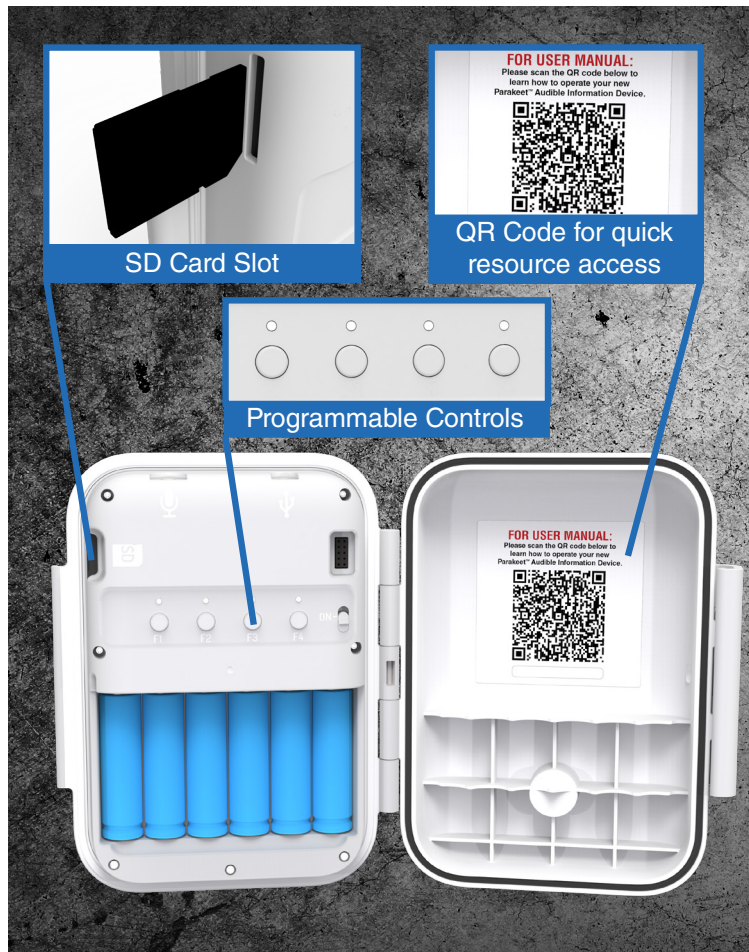

CRASHGARD™ SAND BARREL:

CrashGuard™ Sand Barrel System is a non-redirective, gating sand barrel, or crash cushion.

CRASHGARD FEATURES AND BENEFITS:

- » CrashGuard is blow-molded from high molecular, high-density polyethylene plastic (HLM/HDPE) that produces a **stronger** sand barrel
- » **UV stabilizers maximize product life and color-stable pigments resist fading.**
- » **CrashGuard withstands minor impacts during routine handling and easily stacks for storage and transport**
- » Squared bottom **accepts forklifts**
- » Tiered top **accepts CrashGuard Hoist**
- » Designed for 4" and 6" wide retroreflective sheeting that meets all state and federal specifications and is available in Engineer, Hi-Intensity, and Fluorescent grades
- » CrashGuard is designed for use in posted speed limits from 25-75 mph (contact PSS for other speeds)
- » **One CrashGuard Sand Barrel accommodates all weight requirements to reduce inventory costs and required storage space:**
 - » With insert: 200, 400, 700, or 1,400 lbs.
 - » Without insert: 2,100 lbs.

See the CrashGuard product guide for recommended design arrays by speed limit.

CRASHGARD HOIST SAND BARREL LIFT RING:

CrashGuard Hoist provides **safer and easier transport** of CrashGuard Sand Barrel System.

- » Transport of barrels can be a **one-person operation**
- » Can hoist a fully weighted CrashGuard
- » Operates with a simple scissor action
- » Made of welded steel. Weighs 140 lbs.
- » Powder-coated paint **helps deter corrosion**

**CRASHGARD WEIGHTS:**

The CrashGuard insert allows for various weights necessary for crash cushion arrays.

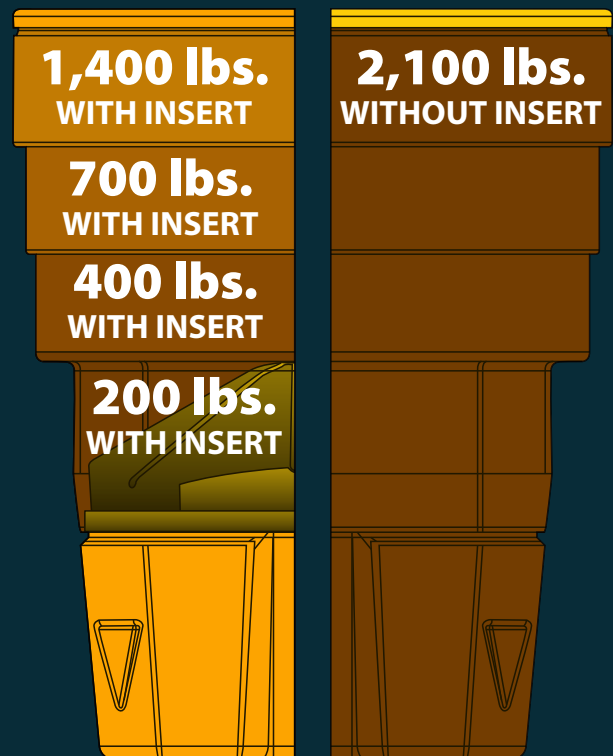

Patents: <http://bit.ly/3cHVTp8>

**LIFEGARD II™ TRAFFIC DRUM:**

PSS pioneered the rubber tire-collar ballasted “LifeGard” drum in the early 1990s, becoming a roadway icon. We later introduced the LifeGard II Drum, which remains the preferred choice today.

LIFEGARD II DRUM FEATURES:

1. Manufactured from high-density polyethylene plastic with **UV inhibitors**. The molded handle accommodates Type A and C warning lights.
2. Intermittent stacking rims **prevent drums from locking when stacked and protect sheeting**.
3. Anti-roll design is a flat section with a rubber piece mounted to the LifeGard for **stabilization against high speed traffic**.
4. Designed for up to five bands of retroreflective sheeting. Shheeting available in 4" and 6" widths. Shheeting **meets all state and federal specifications** and is available in Engineer, Hi-Intensity, and Fluorescent grades.
5. Designed for use with rubber tire collar ballast. Internal rubber base, 25 or 40 lbs., also available. **Ballast made from 100% recycled material**.
6. “Hot Stamp” ink permeates plastic and resists damage during normal use. (Stencil ink lays on surface, does not permeate plastic.) Add your company logo to the bottom of LifeGard II or 42" Navigator to better **identify your product and reduce possible theft**.

Patents: <http://bit.ly/3cHVTp8>

NAVIGATOR™ CHANNELIZERS

**NAVIGATOR™ CHANNELIZER:**

Navigator is the choice to divide opposing lanes, channelize road users, delineate short duration maintenance or utility work, and much more. Navigator's light weight design allows for easier, safer installation and its stackable design saves space.

NAVIGATOR CHANNELIZER FEATURES:

1. Navigator is manufactured from low-density polyethylene plastic with **UV inhibitors**. The handle serves as a “roping-off” mount.
2. Molded handle **accepts Types A and C warning lights and audible information devices**.
3. 42" Navigator accommodates up to five bands of 4" or 6" sheeting, 28" Navigator (see insert) up to three bands. Retroreflective sheeting meets all state and federal specifications and is available in Engineer, Hi-Intensity, and Fluorescent grades.
4. “Hot Stamp” ink permeates plastic and resists damage during normal use (stencil ink lays on surface, does not permeate plastic). **Add your company logo to the bottom of LifeGard II or 42" Navigator to better identify your product and reduce possible theft**.
5. Navigator shown with hexagonal base. Available in 10 or 16 lb. weights. 30 lb. base available. **Ballast manufactured from 100% recycled material**.

Patents: <http://bit.ly/3cHVTp8>

LANEGARD3™ FOLDABLE TYPE III BARRICADE:

LaneGard's one-piece design folds for storage and transport and unfolds for use, **taking only seconds for set up and tear down.** Weighing only 17 lbs. without centerboards, one person can easily fold and unfold LaneGard 3 for transport and deployment.

LaneGard3 is designed for use with PSS Wave™ Centerboards. Wave Centerboards are available in 4', 6', and 8' lengths, and retroreflective sheeting is available in Engineer, Hi-Intensity, and Diamond Grades. Retroreflective sheeting meets all state and federal specifications. Wave accepts sheeting on one or both sides. See page 23 for more details.

LANEGARD3 UPRIGHT FEATURES:

1. Molded-in warning light mount **accepts LED Types A and C warning lights**
2. Recessed molded through-holes on the frame and Wave Centerboards allow for **flush-mounted hardware**
3. Use of sandbags or PSS tire collars for additional ballast
4. Rubber anti-skid feet can provide additional stability (two per crossbar)
5. **Folds to under 3" wide for convenient storage**
6. **Once assembled, always assembled**

Patents: <http://bit.ly/3cHVTp8>

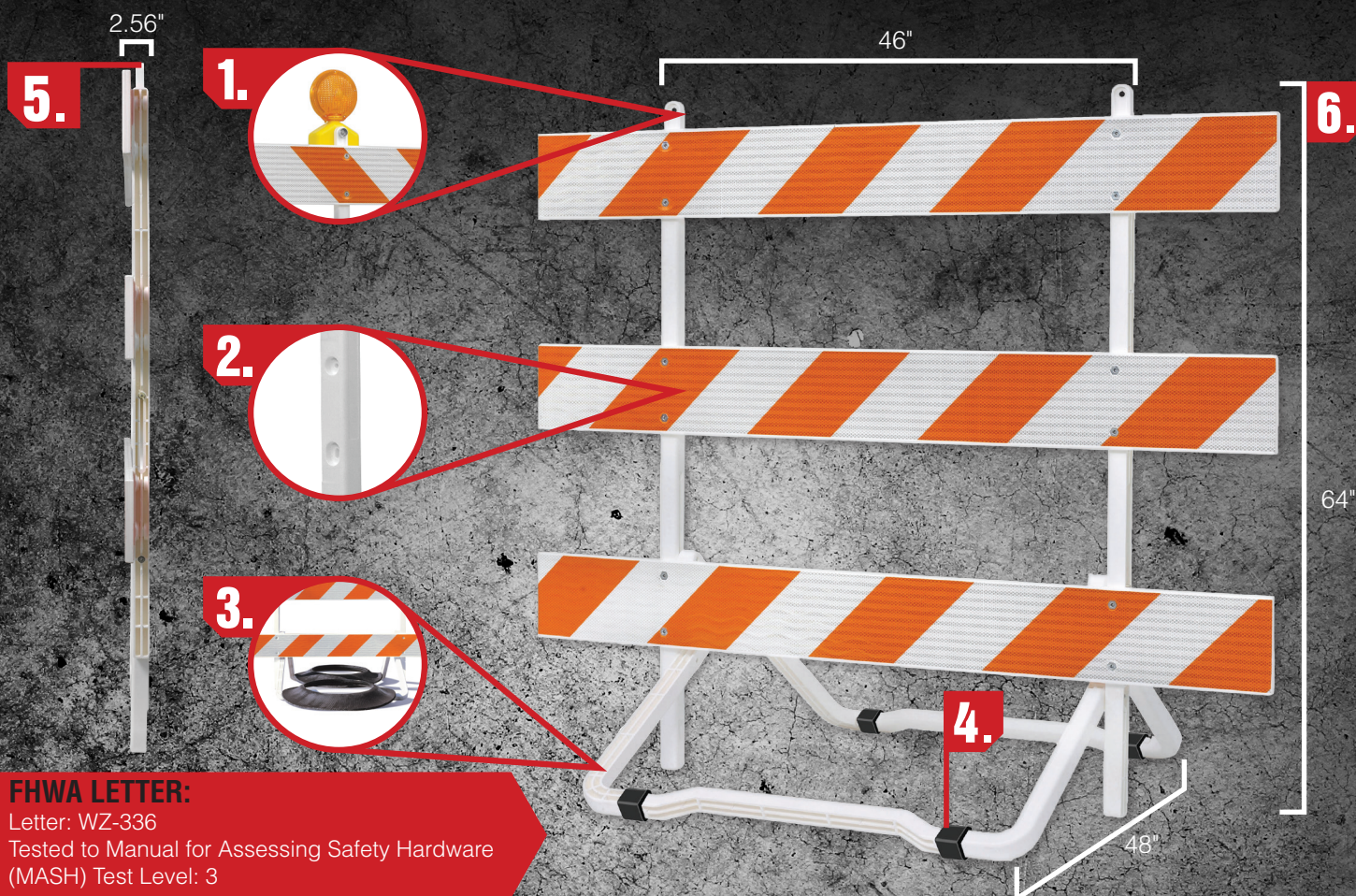
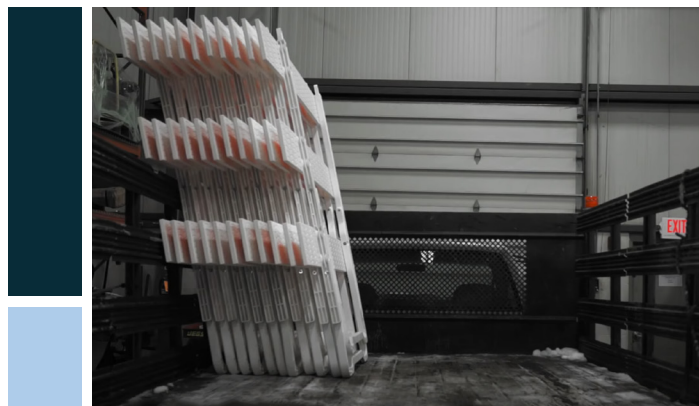
**FHWA LETTER:**

Letter: WZ-336

Tested to Manual for Assessing Safety Hardware (MASH) Test Level: 3

ANCHOR™ MAST™ SYSTEM:

Anchor Mast Type III Barricade consists of Anchor Mast Upright, Anchor Base, and Wave Centerboard.

The Anchor Mast system is manufactured from high-density polyethylene plastic with **UV stabilizers to improve longevity**.

ANCHOR MAST SYSTEM FEATURES:

1. Mast Upright features molded-in warning light mount for Type A and C warning lights. Mounting holes can hold up to two flags on the front and back.
2. **Mast Upright's molded through-holes add strength and support; attachment of Wave Centerboards is faster.**
3. Wave Centerboards are available in 4', 6', and 8' lengths. Retroreflective sheeting is available in Engineer, Hi-Intensity, and Diamond Grades. Retroreflective sheeting meets all state and federal specifications. Wave accepts sheeting on one or both sides.
4. Anchor Base is available in two lengths — 48" and 60".

MAST UPRIGHT FEATURES:

5. Molded through-holes are recessed for **flush-mounted hardware which protects sheeting.**
6. Raised Centerboard Locators make installation of Wave Centerboards **easier and faster.**

LIGHT AND FLAG MOUNT FEATURES:

7. The Light and Flag Mount (LFM) accessory (sold separately) attaches to Perforated Stainless Steel Tube (PSST) uprights. The mount accepts one or two flags and one warning light. Manufactured from high-density polyethylene plastic with UV stabilizers. PSS does not offer PSST uprights for sale.

ANCHOR BASE FEATURES:

8. Available in two styles: for plastic uprights or PSST uprights. Anchor Base for plastic uprights features a 4" x 4" mount. Anchor Base for PSST uprights features a 1 3/4" x 1 3/4" mount. "Press-fit" installation means **no tools required** to attach uprights. Includes molded-in carrying handle.
9. Base features molded in fill-hole and cap to fill with sand. Anchor 48" holds 45 lbs., Anchor 60" holds 60 lbs.
10. Rubber anti-skid pad on the underside of the base helps **increase traction and decrease movement.**



Patents: <http://bit.ly/3cHVTp8>

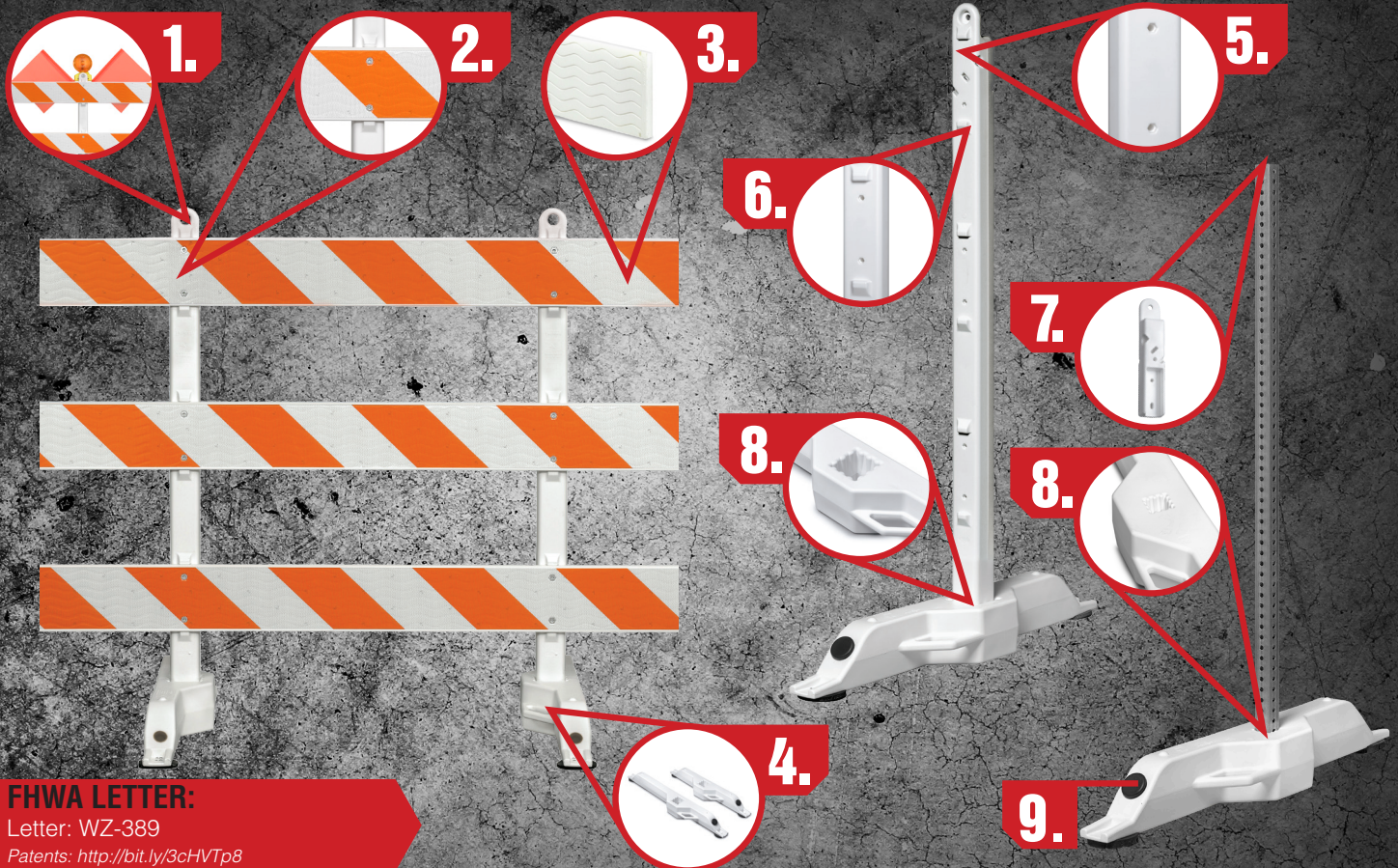

FHWA LETTER:

Letter: WZ-389

Patents: <http://bit.ly/3cHVTp8>

F&A FRAME™ BARRICADE:

F&A Frame Barricade functions as a Type I or Type II barricade. F&A Frame is manufactured from high-density polyethylene plastic with **UV inhibitors**.

PSS Wave™ centerboard is ideal for use with F&A Frame. See page 23 for more on Wave Centerboards.

Other features of the F&A Frame include molded ridges that add **strength and durability** and an oversized sand-fill hole that allows for added ballast.

Patents: <http://bit.ly/3cHVTp8>



F&A FRAME BARRICADE FEATURES:

1. Molded-in, ergonomic handle allows for easier handling and accepts Types A and C warning lights.
2. In addition to Wave centerboards, also accepts plastic, I-beam, or wood centerboards.
3. Molded, heavy gauge feet add **balance and durability**.

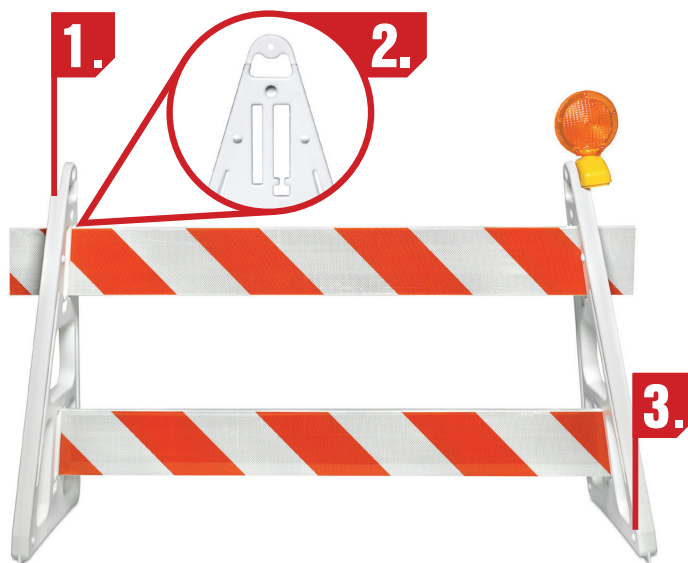

MVP™ VERTICAL PANEL

Ballast made
from 100%
recycled material.



MVP™ VERTICAL PANEL:

MVP serves as a channelizer to direct traffic or as a barricade to divide lanes. MVP is manufactured from high-density polyethylene plastic with **UV inhibitors**.

MVP's **recessed panel protects the retroreflective sheeting**. Retroreflective sheeting meets all state and federal specifications and is available in Engineer, Hi-Intensity, and Diamond grades.

MVP™ VERTICAL PANEL FEATURES:

1. Molded handle accepts Types A and C warning lights.
2. Recessed Panel is 12" wide. Available in 24" or 36" lengths. 12" x 36" panel shown. Panel can be removed for reuse.
3. **Stacks for compact transport and storage.**
4. Features a molded-in foot step for an **easy press-fit assembly** into the base.
5. The base weighs 45 lbs. and is manufactured from **100% recycled material**.

Patents: <http://bit.ly/3cHVTp8>

FHWA LETTER:

Letter: WZ-166

Patents: <http://bit.ly/3cHVTp8>



FIRSTGARD™ FOLDING CONE:

FirstGard is a patented, foldable traffic cone that can be **deployed instantly**. Lightweight but heavy enough to remain stable in most conditions, FirstGard is designed to be **transport-friendly**, enabling the storage of multiple units while requiring **minimal storage space**. Lab testing shows FirstGard offers up to **twice the reflectivity of traditional 28" cones**.

This innovation in channelizing devices provides both TTC operations and emergency management teams with **increased conspicuity and visibility** while in conformity with the MUTCD.

FIRSTGARD FEATURES:

- » Stands 28.75" tall when deployed
- » **Folds to just 1.5" wide**
- » Notched board at the top of the cone for caution tape
- » Rubber feet provide **additional stability**
- » Available in orange and safety green

Patents: <http://bit.ly/3cHVTp8>



FIRSTGARD DIMENSIONS

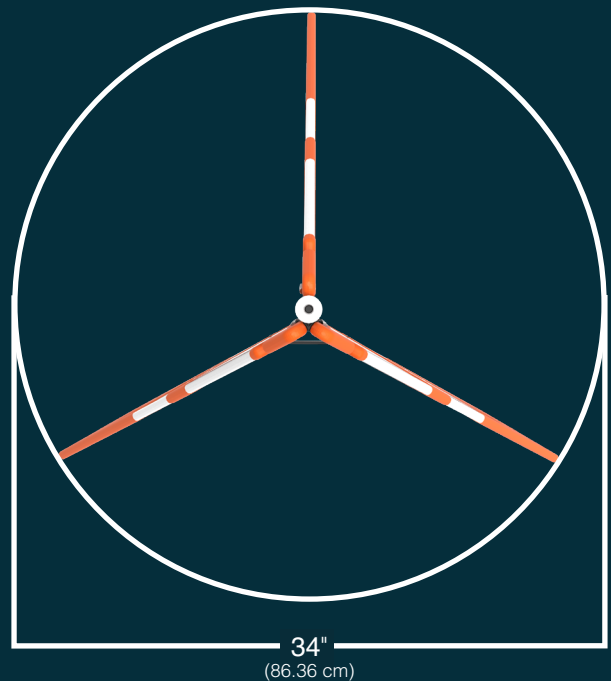
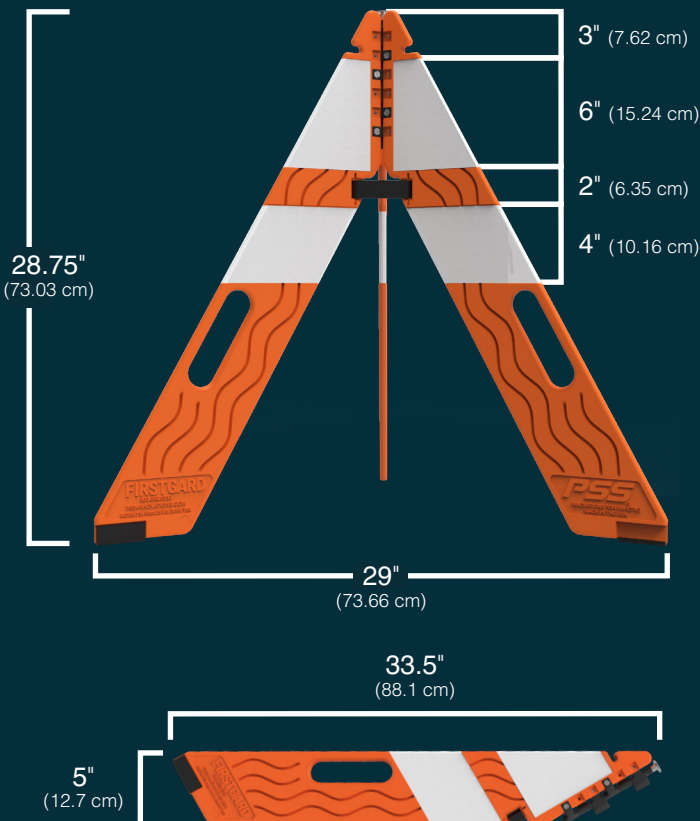

NITELITE II™ REFLECTIVE SAFETY FENCE:

Day or night, NiteLite II Reflective Fence protects pedestrians and drivers with continuous visual delineation. Ideal for work zones, crowd control, and construction sites.

NiteLite's three stripes of conspicuity delineates fixed objects located close to pedestrian or vehicular traffic, clearly channelizing around obstacles.

NITELITE II FEATURES:

- » **Features three 1"-wide, retroreflective high-intensity prismatic (HIP) stripes**
- » Made of orange UV-protected polyethylene plastic
- » Standard roll: 4' x 50'; Weighs: 25 lbs.
- » **Reusable, lightweight, and easy to install**
- » **Rolls easily for storage**
- » NiteLite II satisfies Iowa DOT safety closure specifications for road closures

**QUIK-MARK™ OBJECT MARKER FEATURES:**

Quik-Mark Object Marker delineates temporary or permanent barriers and other objects near the roadway.

- » Consists of a durable, flexible, high-density polyethylene plastic reflective panel that mounts on a high-impact plastic "L"-shaped bracket.
- » Standard panel sizes are 6" W x 12" H and 8" W x 12" H reflective area. Other sizes available. Quik-Mark accepts sheeting on one or both sides.
- » Retroreflective sheeting meets all state and federal specifications. Available in Hi-Intensity and Fluorescent grades.
- » Standard sheeting colors are orange, white and yellow. Red available upon request.

Patents: <http://bit.ly/3cHVTp8>

**QUIKGARD™ GUARDRAIL DELINEATOR FEATURES:**

QuikGard Guardrail Delineator is ideal for entrance/exit ramps, work zones, low-visibility areas, high speed roads.

- » Patented notch provides vertical and horizontal alignment for **fast, easy installation**.
- » Manufactured from durable, flexible, high-density polyethylene plastic with **UV stabilizers**.
- » Retroreflective sheeting meets all state and federal specifications. Available in Hi-Intensity and Fluorescent grades. Available in white, yellow, and red. **Accepts sheeting on one or both sides.**

Patents: <http://bit.ly/3cHVTp8>



3" x 4"
reflective area
Delineator "I"



4" x 6 1/2"
reflective area
Delineator "L"



4" x 13"
reflective area
Delineator "T"



BAM™ BARRIER DELINEATOR FEATURES:

BAM Barrier Delineator is designed for top-mounted or side-mounted applications for permanent or temporary barriers.

- » **Unique, flexible hinge design can reduce replacement costs.** BAM is available with retroreflective sheeting or acrylic reflective lens.
- » BAM accepts sheeting or lenses on one or both sides. Retroreflective sheeting provides 11.5 square inches of reflective area. Acrylic lens provides 8.9 square inches.
- » Standard sheeting colors are white and yellow. Other colors available upon request. Acrylic lens colors include amber, red, blue, or clear.
- » Retroreflective sheeting meets all state and federal specifications and is available in Hi-Intensity and Fluorescent grade sheeting.

Patents: <http://bit.ly/3cHVTp8>

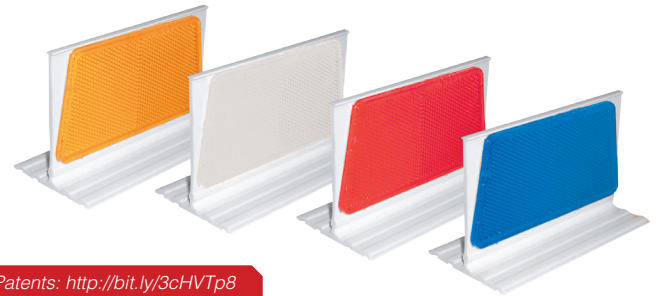

Patents: <http://bit.ly/3cHVTp8>



WAVE™ CENTERBOARD:

Wave Centerboards are engineered for peak performance and ease of installation. Blow-molded from UV-stabilized, high density polyethylene plastic with a reinforced structure, and featuring **encapsulated ends to prevent snagging, moisture buildup, and insect infestations** caused by open board ends, Wave has been designed with users in mind.

WAVE CENTERBOARD FEATURES:

- » **Wave pattern design strengthens the centerboard and improves durability**
- » Retroreflective sheeting meets all state and federal specifications and is available in Engineer, Hi-Intensity, and Diamond grades.
- » Available in 4', 6', and 8' lengths. Accepts sheeting on one or both sides.
- » Ideal for use with our type I, II, and III barricades.



Designed with Anchor Mast Upright for a close-tolerance barricade system.

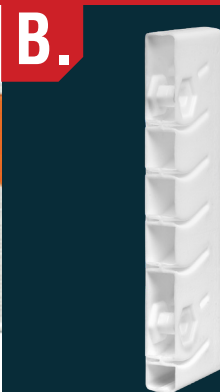

Molded through-holes add strength & support. Recessed holes accommodate flush-mounted hardware, protecting installers and sheeting.

RUBBER TIRE COLLAR FEATURES:

Weight: 22-25 lbs.

Color: Black, no paints or markings of any color

Inside Diameter: 21.75"

Outside diameter: 35" - 36.5"

Rubber Tire Collar provides significant ballast for drums, barricades, and other traffic control devices.

Makes positive contact with road when installed on drums.

Cut from 22.5" truck tires, **100% recycled material.**



PLASTIC SAND BAG FEATURES:

Weight: Holds up to 25 lbs. of sand

Color: Safety Orange

Dimensions: 14" W x 26" L

Plastic sand bags provide significant ballast for drums, barricades, and other traffic control devices.

Plastic sand bags are made of 850 lb. weight denier polypropylene plastic with **UV stabilizers.**





CONTACT:

Call 800-662-6338 to talk to a Customer Service Representative.

HOURS:

8 AM to 5 PM (ET)
Monday through Friday

Follow us on:



*We don't just talk about Innovations for
Safety™ — we live it.*

PSS | 2444 Baldwin Road, Cleveland, OH 44104
800-662-6338 | PSS-Innovations.com
Copyright © 2024 | 02/25

**SCAN TO VIEW
OUR ENTIRE
CATALOG ONLINE**

